



Crafted to **wonder**

belfires. fireplaces

Crafted to wonder

■ Wij begrijpen als geen ander wat een haard aan het leven kan toevoegen. Al sinds 1976 bieden wij de ultieme vuurbeleving. Met passie, hartverwarmend vakmanschap en oog voor detail maken wij in onze eigen fabriek in Nederland excellente gas- en houthaarden. Wij maken jouw haard met gevoel voor stijl; tijdloos of eigentijds. Er is keuze uit een breed assortiment modellen en oneindig veel mogelijke combinaties. Onze haarden zijn van hoge kwaliteit en werken veilig en probleemloos. Je kunt rekenen op een bijzonder goede service en vakkundige hulp bij het onderhoud van je haard. Laat je verwonderen door onze haarden, en maak momenten magisch. Staar in de vlammen en zweef naar andere gedachten.

■ We understand better than anyone how much a fireplace can enrich your life. Since, 1976, we have been providing the ultimate fire experience. With passion, heart-warming craftsmanship and attention to detail, we manufacture outstanding gas and wood fires in our factory in the Netherlands. We create your fireplace with a sense of style: timeless or contemporary. The choice includes a wide range of models and infinite possible combinations. Our fires are high quality and work safely and problem-free. You can count on an exceptionally good service and professional help with maintaining your fireplace. Our fireplaces are made to wonder and create magical moments. Stare into the flames and let yourself relax.

■ Nous savons mieux que quiconque comment un foyer peut enrichir la vie. C'est depuis 1976 déjà que nous offrons l'expérience ultime du feu. Avec passion, un savoir-faire incomparable et le souci du détail, nous fabriquons d'excellents appareils au gaz et au bois dans notre propre usine aux Pays-Bas. Nous fabriquons votre appareil avec le sens du style : intemporel ou contemporain. Il y a le choix entre un large assortiment de modèles, avec d'infinies possibilités de combinaison. Nos appareils sont de qualité supérieure et fonctionnent en toute sécurité et sans le moindre problème. Vous pouvez compter sur un service après-vente particulièrement efficace et sur une assistance spécialisée pour l'entretien de votre appareil. Laissez-vous surprendre par nos appareils, et rendez ces moments magiques. Fixez les flammes et évadez-vous vers d'autres pensées.

■ Sappiamo meglio di chiunque altro quello che un camino può aggiungere alla tua vita. Dal 1976 offriamo un'esperienza del fuoco irripetibile. È con passione, maestria ed attenzione al dettaglio che creiamo nella nostra fabbrica nei Paesi Bassi camini a gas e a legna di qualità eccellente. Creiamo il vostro camino con amore per lo stile, sia che si tratti di un pezzo dallo stile senza tempo o al passo con i tempi moderni. Offriamo una vasta gamma di scelta tra svariati modelli e infinite possibilità di combinazioni. I nostri camini sono di alta qualità, sono affidabili e sicuri. Per la manutenzione del vostro camino potete contare su un'ottima assistenza e aiuto professionale. Lasciatevi sorprendere dai nostri camini e rendete ogni istante magico. Godetevi il gioco delle fiamme e rilassatevi.

Inhoud

Sommaire | Contents | Indice

■ Uitleg catalogus	4	■ Explication catalogue	4	■ Explanation of the catalogue	4	■ Spiegazione catalogo	4
Front haarden	6	Appareils simple face	6	Front fireplaces	6	Camini frontali	6
Modellen	8-39	Modèles	8-39	Models	8-39	Modelli	8-39
Maatschetsen en zichtmaten	34-41	Dessins techniques et cotes apparentes	34-41	Dimension drawings and visual dimensions	34-41	Disegni dimensionali e dimensioni a vista	34-41
Tweezijdige haarden	42	Appareils à deux faces	42	Two-sided fireplaces	42	Camini bifacciali	42
Modellen	44-51	Modèles	44-51	Models	44-51	Modelli	44-51
Maatschetsen	52-55	Dessins techniques	52-55	Dimension drawings	52-55	Disegni dimensionali	52-55
Driezijdige haarden	56	Appareils à trois faces	56	Three-sided fireplaces	56	Camini trifacciali	56
Modellen	58-71	Modèles	58-71	Models	58-71	Modelli	58-71
Maatschetsen	72-75	Dessins techniques	72-75	Dimension drawings	72-75	Disegni dimensionali	72-75
Room Dividers	76	Room Dividers	76	Room Dividers	76	Room Divider	76
Modellen	78-81	Modèles	78-81	Models	78-81	Modelli	78-81
Maatschetsen	82-83	Dessins techniques	82-83	Dimension drawings	82-83	Disegni dimensionali	82-83
Tunnel haarden	84	Foyers tunnel	84	Tunnel fireplaces	84	Camini tunnel	84
Modellen	86-91	Modèles	86-91	Models	86-91	Modelli	86-91
Maatschetsen	92-93	Dessins techniques	92-93	Dimension drawings	92-93	Disegni dimensionali	92-93
Product overzicht	94-99	Vue d'ensemble des produits	94-99	Product overview	94-99	Panoramica dei prodotti	94-99
Advies		Conseil		Advice		Consigli	
Series	100-101	Séries	100-101	Series	100-101	Serie	100-101
Renovatie	102	Rénovation	102	Renovation	102	Ristrutturazione	102
Convectie ventilator	102	Ventilateur de convection	102	Convection fan	102	Ventilatore ambiente	102
Gassoorten	103	Types de gaz	103	Gas types	103	Tipi di gas	103
Afstandsbediening en WiFi	104	Télécommande et Wi-Fi	104	Remote control and WiFi	104	WiFi / telecomando	104
Overzicht schakelbare branders	105-109	Vue d'ensemble des brûleurs modulables	105-109	Overview of switchable burners	105-109	Panoramica bruciatori	105-109
Interieur	110	Intérieur	110	Interior	110	Interni	110
Brander decoratie	111	Décorations de brûleur	111	Burner decorations	111	Decorazione bruciatori	111
Overzicht kaders	112-114	Vue d'ensemble des cadres	112-114	Overview of frames	112-114	Panoramica cornici	112-114
Opti-Vent	115	Opti-Vent	115	Opti-Vent	115	Opti-Vent	115
Service en garantie	116	Service et garantie	116	Service and warranty	116	Assistenza e garanzia	116

Legenda

Légende | Legend | Legenda

1. Uitleg catalogus
Explication catalogue | Explanation of the catalogue | Spiegazione catalogo

2. Front haarden
Appareils simple face | Front fireplaces | Camini frontali

3. Tweezijdige haarden
Appareils à deux faces | Two-sided fireplaces | Camini bifacciali

4. Driezijdige haarden
Appareils à trois faces | Three-sided fireplaces | Camini trifacciali

5. Room Dividers
Room Dividers | Room Dividers | Room Divider

6. Tunnel haarden
Foyers tunnel | Tunnel fireplaces | Camini tunnel

7. Product overzicht
Vue d'ensemble des produits | Product overview | Panoramica dei prodotti

8. Advies
Conseil | Advice | Consigli



Uitleg catalogus

Explication catalogue | Explanation of the catalogue | Spiegazione catalogo

1 Model en formaat

Modèle et format | Model and size | Modello e dimensioni

- Kies afhankelijk van je interieur het gewenste model en formaat.
- En fonction de votre aménagement, choisissez le modèle et le format souhaité.
- Depending on your interior design, select your required model and size.
- Scegliere in base all'allestimento il modello e le dimensioni desiderate.

- Front haarden
- Appareils simple face
- Front fireplaces
- Camini frontali

- Tweezijdige haarden
- Appareils à deux faces
- Two-sided fireplaces
- Camini bifacciali

- Driezijdige haarden
- Appareils à trois faces
- Three-sided fireplaces
- Camini trifacciali

- Room Dividers
- Room Dividers
- Room Dividers
- Room Divider

- Tunnel haarden
- Foyers tunnel
- Tunnel fireplaces
- Camini tunnel

2 Series

Séries | Series | Serie

- Binnen het Bellfires assortiment zijn er verschillende series die ieder hun specifieke voordelen bieden. Dit wordt omschreven bij de onderstaande series.

- Original Bell | Toestellen uit de Original Bell serie zijn gesloten inbouw gashaarden. Deze serie biedt de meeste inbouwmogelijkheden en keuzevrijheid. Door de uitgebreide variatie aan maten is er voor elk interieur een passende haard.
- Smart Bell | Toestellen uit de Smart Bell serie zijn gesloten haarden die geschikt zijn voor zowel inzet als inbouw. Door hun geringe diepte zijn ze extra geschikt bij renovatie. Ze zijn eventueel ook uit te rusten met een ventilator. Deze ventilator zorgt voor een extra snelle spreiding van de warmte in de ruimte.

- L'assortiment Bellfires compte plusieurs séries qui présentent chacune leurs avantages spécifiques. Ces derniers sont décrits pour les séries ci-dessous

- Original Bell | Les appareils de la série Original Bell sont des foyers concentriques au gaz. Cette série offre le plus de possibilités d'encastrement et de liberté de choix. Grâce aux nombreuses dimensions, il y a toujours un appareil adapté à chaque intérieur.
- Smart Bell | Les appareils de la série Smart Bell sont des inserts concentriques qui peuvent servir tant pour la rénovation que pour la création. Ils peuvent éventuellement aussi être équipés d'un ventilateur, qui assure une distribution très rapide de la chaleur dans la pièce.

- There are different series within the Bellfires range of products - each one with its specific advantages. These are explained for each series below.

- Original Bell | Appliances from the Original Bell series are closed built-in gas fireplaces. This series offers the most built-in options and freedom of choice. The wide variety of sizes makes this fireplace suitable for any interior.
- Smart Bell | Appliances from the Smart Bell series are closed fireplaces that are suitable as insert or built-in. Their limited depth makes them exceptionally suitable for renovation projects. They can also be fitted with a fan. This fan improves the heat dispersion in the room.

- La gamma Bellfire comprende diverse serie, ciascuna ricca di specifici vantaggi. Di seguito una loro descrizione.

- Original Bell | I dispositivi della serie Original Bell sono monoblocchi a flusso bilanciato. Questa serie offre innumerevoli possibilità di installazione e grande libertà di scelta. Grazie alla grande varietà di misure, esiste un camino adatto per ogni casa.
- Smart Bell | I dispositivi della serie Smart Bell sono camini chiusi che possono essere installati sia come monoblocchi sia come inserti. Grazie alla loro modesta profondità sono ideali per l'utilizzo in interventi di ristrutturazione di camini esistenti. È eventualmente possibile equipaggiarli di sistema di ventilazione. La ventilazione fa in modo che il calore venga rapidamente distribuito nell'ambiente.

3 Uitvoering en opties

Version et options | Model and options | Versioni e optional

- Afhankelijk van de door jou gekozen serie zijn er diverse uitvoeringen en opties mogelijk.
- Plusieurs versions et options sont possibles selon la série que vous avez choisie.
- Several designs and options are available, depending on the series that you select.
- Sulla base della serie scelta, sono disponibili diverse versioni e optional.

- Renovatie
- Rénovation
- Renovation
- Ristrutturazione

- Brander decoratie
- Décorations de brûleur
- Burner decoration
- Decorazione bruciatore

- Convection ventilator
- Ventilateur de convection
- Convection fan
- Ventilatore ambiente

- Kader
- Cadres
- Frame
- Cornice

- Gassoorten
- Types de gaz
- Gas types
- Tipo di gas

- Afstandsbediening
- Télécommande
- Remote control
- Telecomando

- Brander type
- Types de brûleur
- Burners type
- Tipo di bruciatore

- WiFi
- Wi-Fi
- WiFi
- WiFi

- Interieur
- Intérieurs
- Interior
- Decorazione interna

- Maatschetsen
- Dessins techniques
- Dimension drawings
- Maßskizzen

Front haarden

Appareils simple face | Front fireplaces | Camini frontali

- Fronthaarden bieden een frontaal vuuraanzicht met veel mogelijkheden qua afmeting en techniek voor zowel bestaande als nieuwbouwsituaties.
- Les appareils simple face offrent une vue frontale du feu avec de nombreuses options en matière de dimensions et de techniques, tant pour des constructions existantes que nouvelles.
- Front fireplaces provide a frontal view of the fire with many possibilities in terms of dimensions and techniques in both existing situations and newly built houses.
- I camini frontali offrono una visuale frontale sul fuoco e grazie alle svariate misure e caratteristiche sono adatti a qualsiasi tipo di casa, che si tratti di nuove costruzioni o ristrutturazioni



Topsham Small	8	Horizon Bell XL	18	Smart Bell 75/60	26
Topsham Large	9	Horizon Bell XXL	19	Smart Bell 75/70	27
Derby Small	10	Vertical Bell Small	20	Smart Bell 75/80	28
Derby Large	11	Vertical Bell Medium	21	Smart Bell 80/60	29
York Small	12	Smart Bell 45/60	23	Smart Bell 80/70	30
York Large	13	Smart Bell 55/55	24	Smart Bell 80/80	31
Horizon Bell XS	14	Smart Bell 55/60	24	Smart Bell 90/70	32
Horizon Bell Small	15	Smart Bell 65/55	25	Smart Bell 90/80	33
Horizon Bell Medium	16	Smart Bell 65/60	25		
Horizon Bell Large	17	Smart Bell 75/55	26		

Overzicht uitvoeringen

Vue d'ensemble des versions | Overview of versions | Panoramica delle versioni

Original Bell serie

Derby⁽¹⁾ / Topsham⁽²⁾ / York⁽³⁾

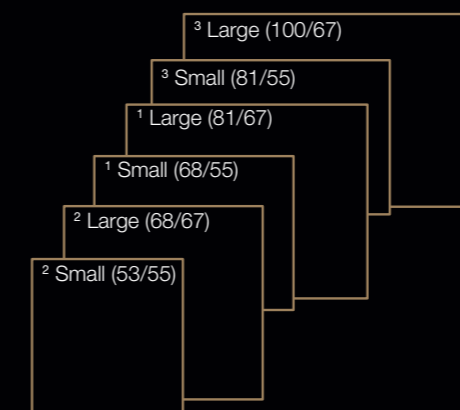

Horizon Bell

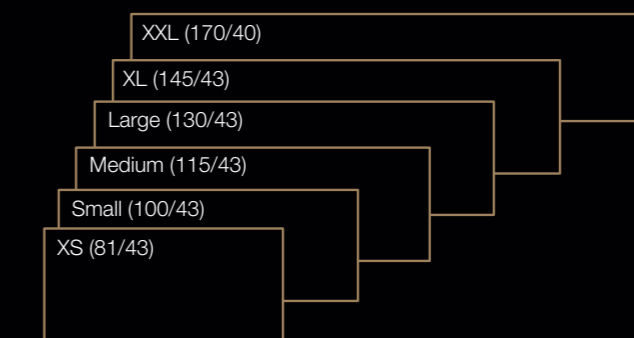

Vertical Bell



Smart Bell serie

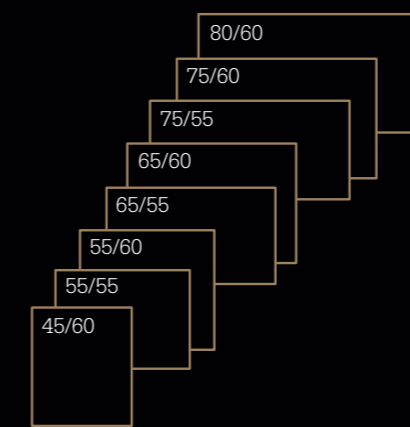

MagniFire

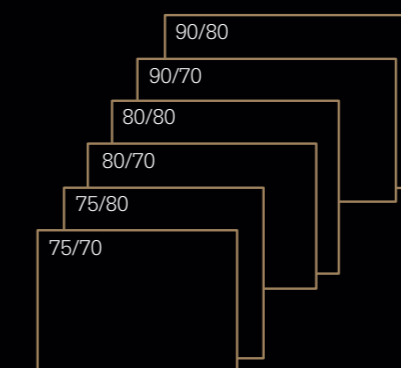

Premium Fire

Topsham



- ORIGINAL BELL SERIE P.94
- PLC P.105-108
- P.110
- P.111
- P.112-114
- P.104
- P.104
- P.103
- P.34



Derby



- ORIGINAL BELL SERIE P.94
- PLC P.105-108
- P.110
- P.111
- P.112-114
- P.104
- P.104
- P.103
- P.34





Kader: Hidden door | Brander: Centre Fire

York



Kader: Floating Frame | Brander: Line Fire

- ORIGINAL BELL
SERIE
P.94
-  PLC
P.105-108
-  P.110
-  P.111
-  P.112-114
-  P.104
-  P.104
-  P.103
-  P.35

Horizon Bell





Kader: Hidden Door | Brander: Line Fire

Horizon Bell



Kader: Hidden Door | Brander: Center Fire

ORIGINAL BELL
SERIE
P.94

PLC
P.105-106

P.110

P.111

P.112-114



P.104

P.104

P.103

P.36

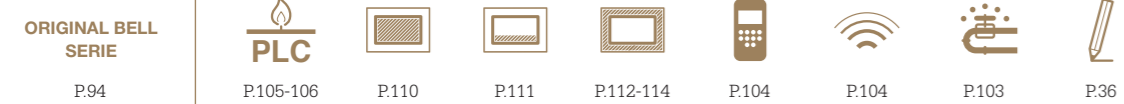
Horizon Bell





Kader: Hidden Door | Brander: Line Fire

Vertical Bell

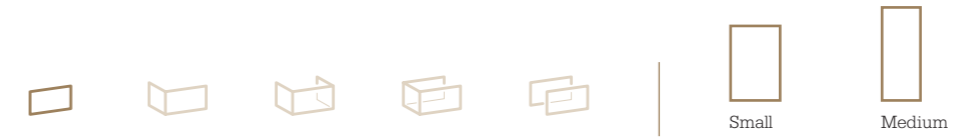

Kader: Floating Frame | Brander: Centre Fire

ORIGINAL BELL
SERIE

P.94



P.105-106



P.110



P.111



P.112-114



P.104



P.104



P.103



P.36-37



Smart Bell

Voor renovatiesituaties | Situations de rénovation | Renovation situations | In caso di ristrutturazioni

- De gashaarden op de volgende pagina's zijn met name geschikt voor bestaande situaties, waarbij een bestaande (open) haard of kachel vervangen wordt door een nieuwe gashaard. Dit worden ook wel renovatiesituaties genoemd. De Smart Bell gashaarden noemt men vanwege deze toepassing ook wel inzethaarden. Door de maatvoering en kadervarianten zijn zij namelijk uitermate geschikt voor bijna elke bestaande situatie. Daarbij zijn deze gashaarden van binnenuit aan te sluiten op het aanwezige rookkanaal en is de techniek van binnenuit benaderbaar, er is dus geen inbouwluikje nodig. Uiteraard zijn de Smart Bell gashaarden ook geschikt voor elke nieuwe situatie.
- Les appareils gaz des pages suivantes sont particulièrement adaptés aux situations existantes dans lesquelles un foyer ou un poêle existant (ouvert) est remplacé par un nouvel appareil gaz. Celles-ci sont également appelées situations de rénovation. C'est pourquoi, Smart Bell appareils gaz sont également appelés inserts. En raison de leurs dimensions et de leurs large gamme de tailles et de cadres, ils conviennent parfaitement à presque toutes les situations existantes. De plus, ces inserts gaz peuvent être connectés de l'intérieur au conduit de fumée existant et de ce fait, aucune trappe d'accès n'est requise. Les Smart Bell appareils gaz sont bien sûr également adaptés à chaque nouvelle situation.
- The gas fireplaces on the following pages are suitable for existing situations where an existing (open) fireplace or stove is replaced by a new gas fire. These are also called renovation situations. Due to this application, the Smart Bell gas fireplaces are also called inserts. The dimensions and framework variants allow them to be extremely suitable for almost every existing situation. These gas fires can be connected from the inside to the existing flue and the electronics are all accessed from the inside, so no installation hatch is required. The Smart Bell gas fireplaces are of course be built into new installation situations.
- I camini a gas nelle pagine seguenti sono particolarmente adatti per le situazioni esistenti in cui un caminetto o stufa esistente (aperto) viene sostituito da un nuovo apparecchio a gas. Queste sono anche chiamate situazioni di rinnovamento. Data questa possibilità di installazione, Smart Bell camini a gas sono anche chiamati inserti. Grazie alla varietà di modelli e cornici disponibili, questi articoli sono estremamente adatti a quasi tutte le situazioni esistenti. Inoltre, questi apparecchi a gas possono essere alla canna fumaria esistente dall'interno e non è necessario un pannello di accesso esterno. Smart Bell camini a gas sono ovviamente adatti anche per essere installati come caminetti in nuove installazioni.



Smart Bell



B

Kader: Verdiept kader 15 mm | Brander: MagniFire

SMART BELL
SERIE
P.94-96

MP
P.107-108

P.110

P.111

P.112-114

P.104

P.104

P.102

P.102

P.103

P.37-38



B

Kader: Verdiept kader 50 mm | Brander: MagniFire



Kader: Klassiek kader | Brander: MagniFire

Smart Bell

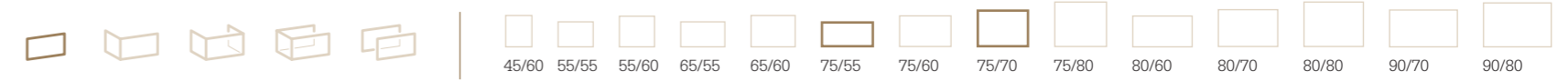

Kader: Verdiept kader | Brander: Premium Fire

- SMART BELL
SERIE
P.94-96
- MP
P.107-108
- P.110
- P.111
- P.112-114
- P.104
- P.104
- P.102
- P.102
- P.103
- P.38

Smart Bell

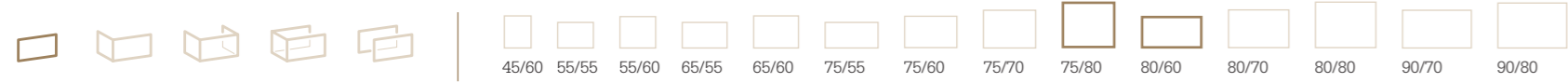

SMART BELL
SERIE
P.94-96



Smart Bell



Kader: Inbouw kader | Brander: Premium Fire

SMART BELL
SERIE
P.94-96



Kader: Klassiek kader | Brander: Premium Fire

Smart Bell



SMART BELL
SERIE
P.94-96





Maatschetsen

Dessins techniques | Dimension drawings | Disegni dimensionali

Topsham Small

Topsham Large

Derby Small

Derby Large

York Small

York Large

Horizon Bell XS

Horizon Bell Small

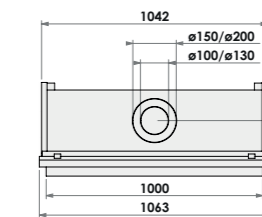
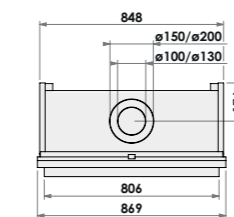
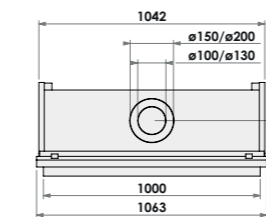
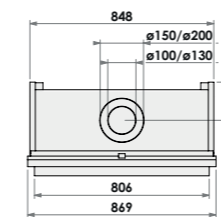
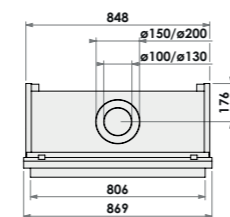
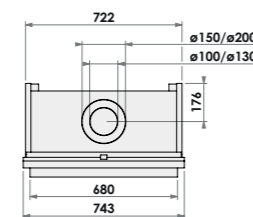
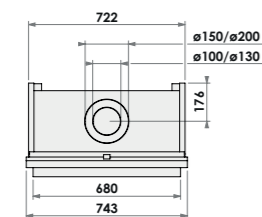
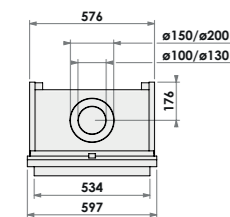
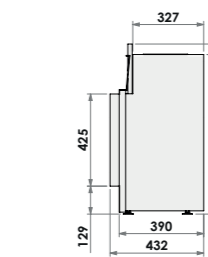
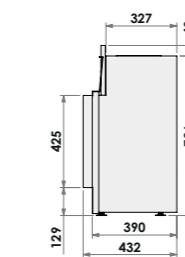
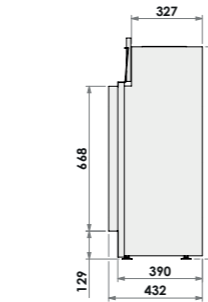
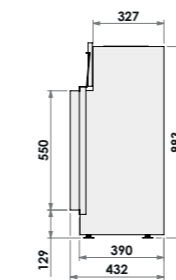
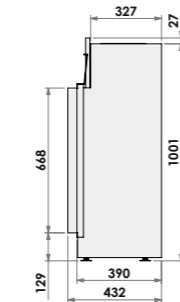
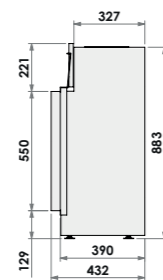
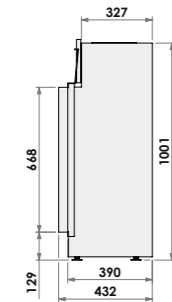
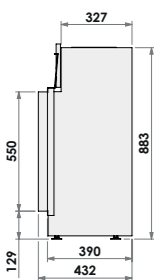
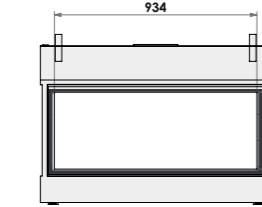
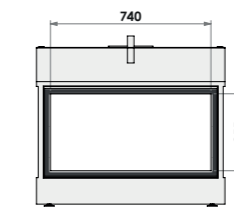
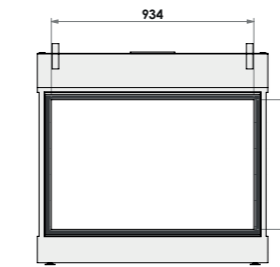
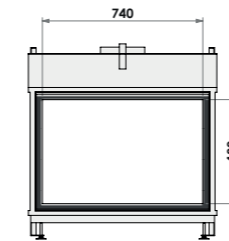
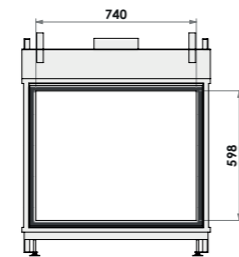
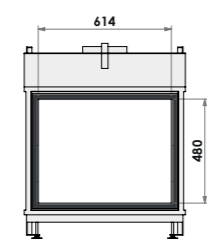
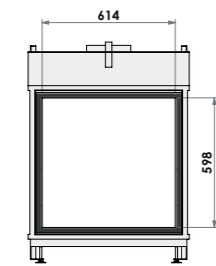
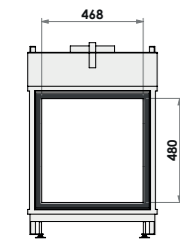



Maatschetsen

Dessins techniques | Dimension drawings | Disegni dimensionali

Horizon Bell Medium

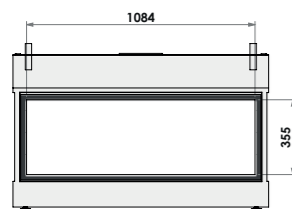

Horizon Bell Large

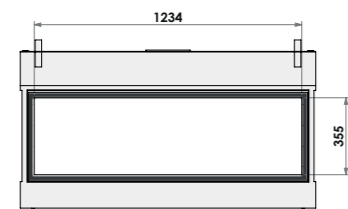

Horizon Bell XL

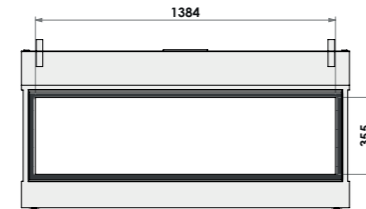

Horizon Bell XXL

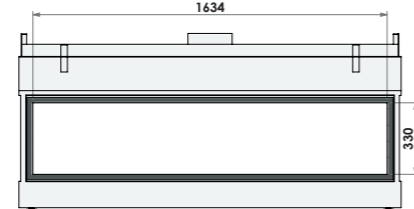

Vertical Bell Small

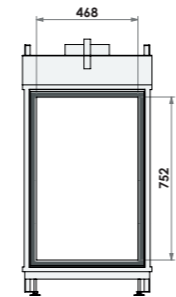

Vertical Bell Medium

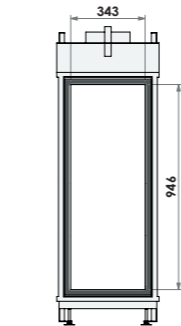

Smart Bell 45/60

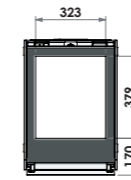

Smart Bell 55/55

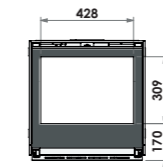

Smart Bell 55/60

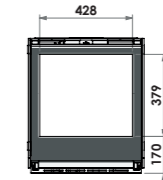

Smart Bell 65/55

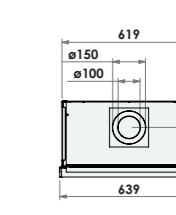
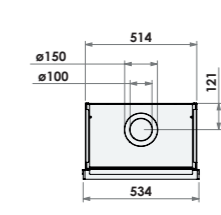
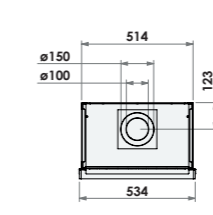
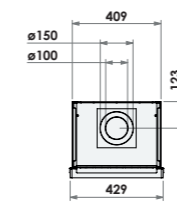
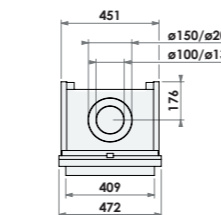
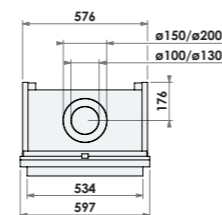
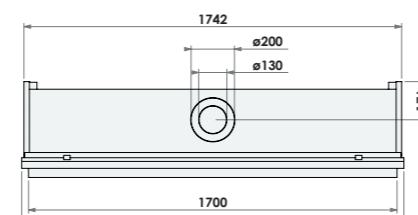
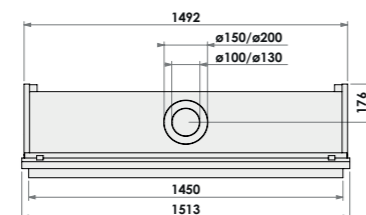
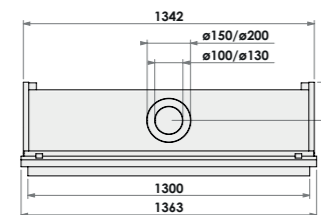
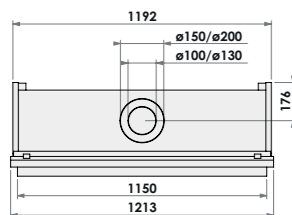
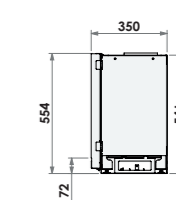
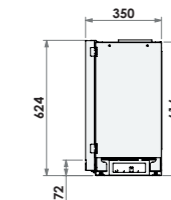
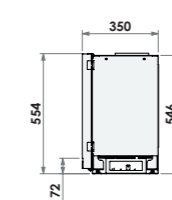
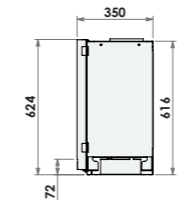
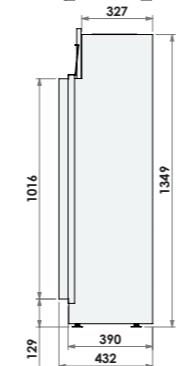
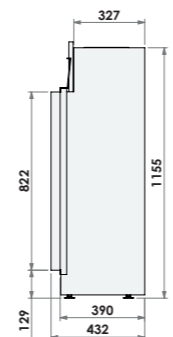
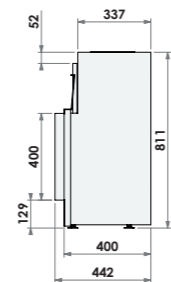
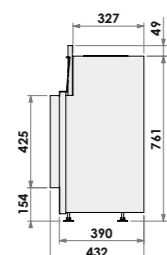
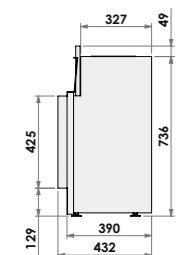
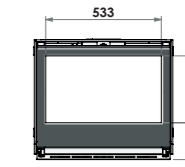



Maatschetsen

Dessins techniques | Dimension drawings | Disegni dimensionali

Smart Bell 65/60

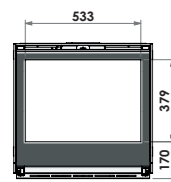

Smart Bell 75/55

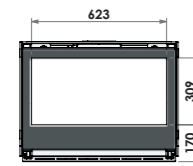

Smart Bell 75/60

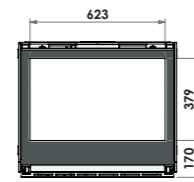

Smart Bell 75/70

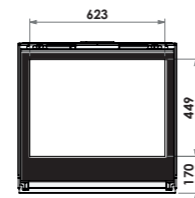

Smart Bell 75/80

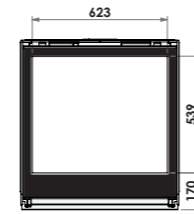

Smart Bell 80/60

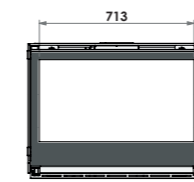

Smart Bell 80/70

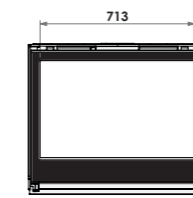

Smart Bell 80/80

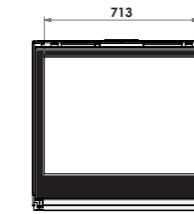

Smart Bell 90/70

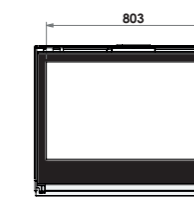

Smart Bell 90/80

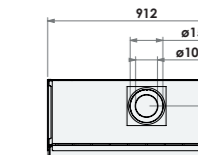
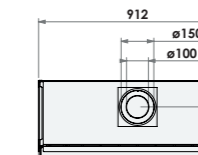
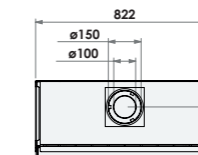
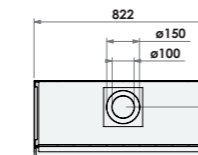
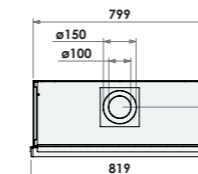
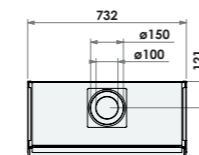
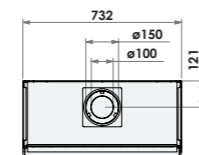
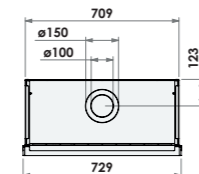
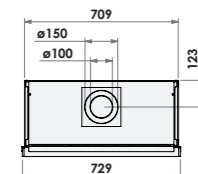
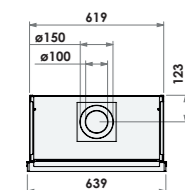
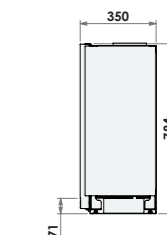
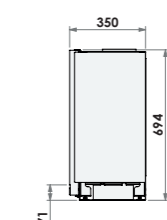
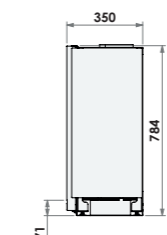
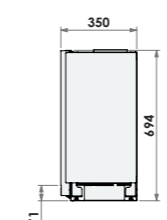
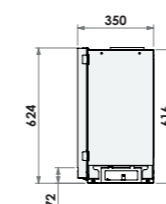
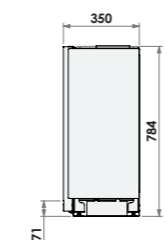
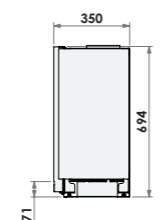
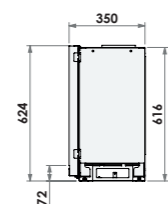
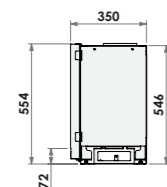
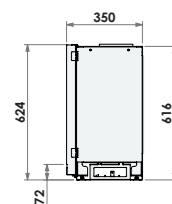
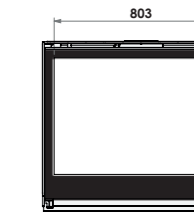

Zichtmaten

Cotes apparentes | Visual dimensions | Dimensioni a vista



Tweezijdige haarden

Appareils à deux faces | Two-sided fireplaces | Camini bifacciali

- De tweezijdige gashaarden van Bellfires beleef je van twee kanten: zowel links als rechts om de hoek. Een vuurbeleving die zijn investering dubbel en dwars waard is.
- Les appareils au gaz à deux faces de Bellfires offrent une expérience sur deux côtés : tant à gauche qu'à droite de l'angle. Une expérience du feu dont l'investissement en vaut vraiment la peine.
- You can enjoy the Bellfires two-sided gas fireplaces from two sides: from left and right corners. This is an experience of the fire that makes your investment truly worthwhile.
- I camini bifacciali Bellfires possono essere ammirati da due lati: sia a sinistra che a destra. Un'esperienza intensa e coinvolgente che vale l'investimento.



Corner Bell Small	44
Corner Bell Medium	45
Corner Bell Large	46
Corner Bell XL	47
Corner Bell XXL	48
Corner Bell Topsham	49
Corner Bell Derby	50
Corner Bell York	51

Overzicht uitvoeringen

Vue d'ensemble des versions | Overview of versions | Panoramica delle versioni

Original Bell serie

Corner Bell | Links

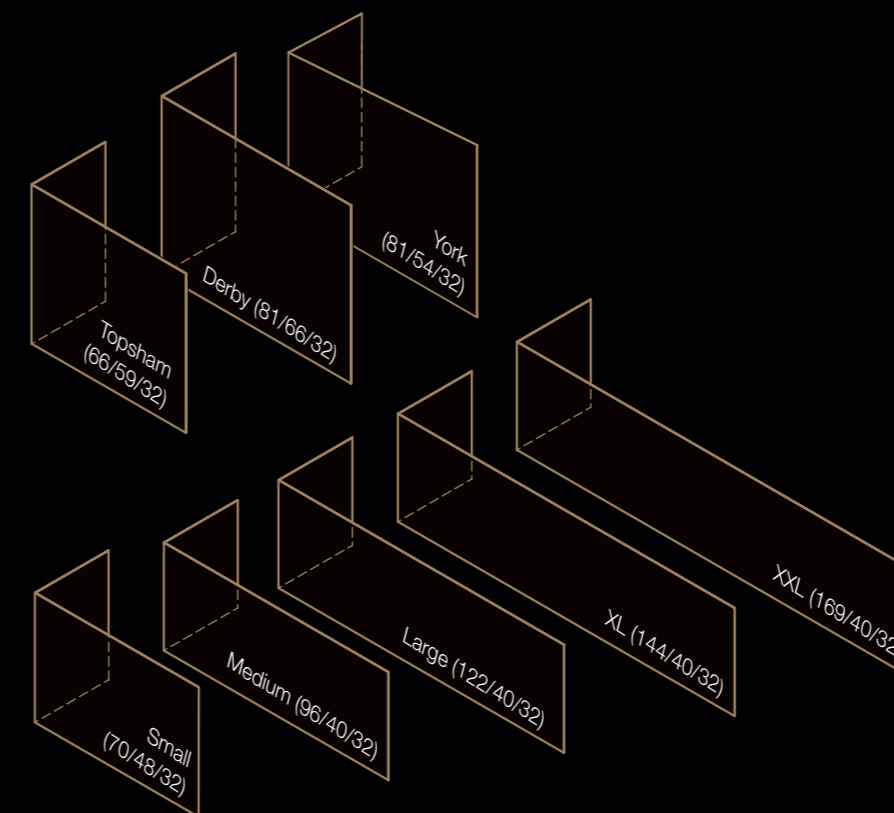

Corner Bell | Rechts

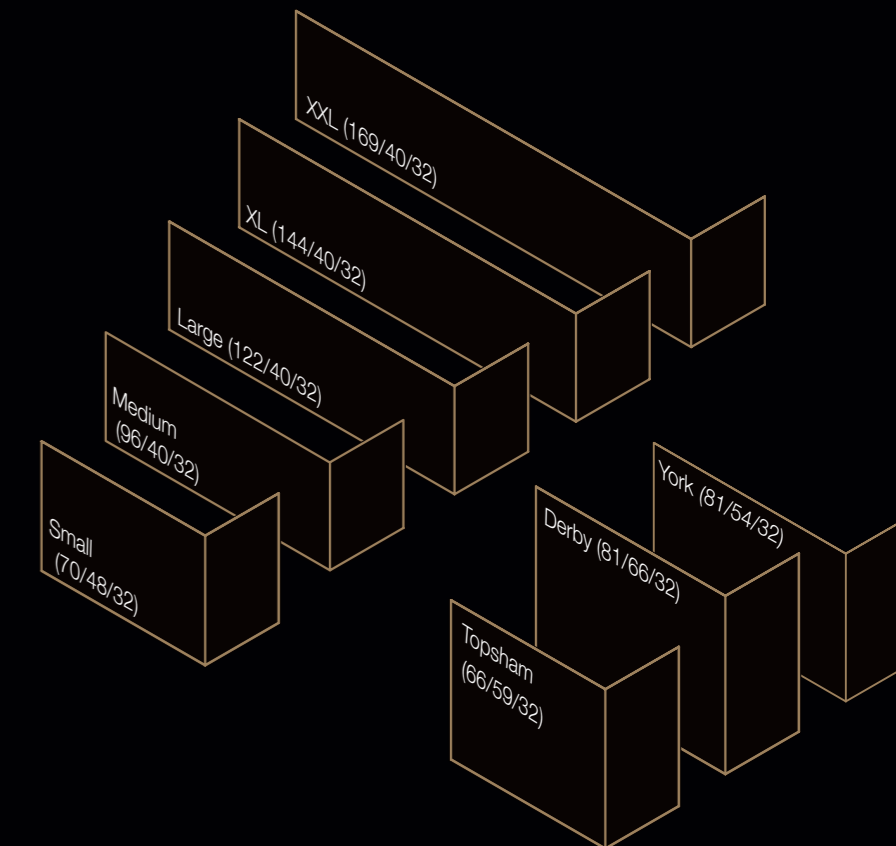

Corner Bell



Kader: Hidden Door | Brander: Line Fire



Kader: Hidden Door | Brander: Centre Fire

- ORIGINAL BELL SERIE
P.94
- PLC
P.105-108
- P.110
- P.111
- P.112-114
- P.104
- P.104
- P.103
- P.52

Corner Bell



Kader: Hidden Door | Brander: Line Fire

ORIGINAL BELL
SERIE
P.96

 LC
P.105-106

 P.110

 P.111

 P.112-114

 P.104

 P.104

 P.103

 P.52-53



Kader: Hidden Door +10 cm | Brander: Centre Fire

Corner Bell



Small



Medium



Large



XL



XXL



Topsham



Derby



York



Kader: Hidden Door +10 cm | Brander: Line Fire



Kader: Hidden Door +10 cm | Brander: Line Fire

ORIGINAL BELL
SERIE

P.96



P.105-106



P.110



P.111



P.112-114



P.104



P.104



P.103



P.53-54



Kader: Hidden Door +10 cm | Brander: Line Fire

Corner Bell



A

Kader: Hidden Door | Brander: Premium Fire

- ORIGINAL BELL
SERIE
P.96
-  PLC
P.105-108
-  P.110
-  P.111
-  P.112-114
-  P.104
-  P.104
-  P.103
-  P.54-55



Maatschetsen

Dessins techniques | Dimension drawings | Disegni dimensionali

Corner Bell Small L

Corner Bell Small R

Corner Bell Medium L

Corner Bell Medium R

Corner Bell Large L

Corner Bell Large R

Corner Bell XL L

Corner Bell XL R

Corner Bell XXL L

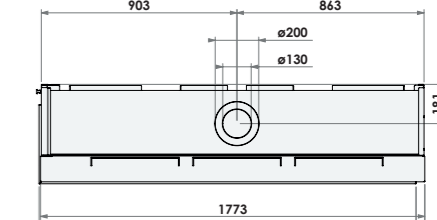
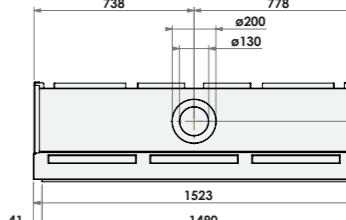
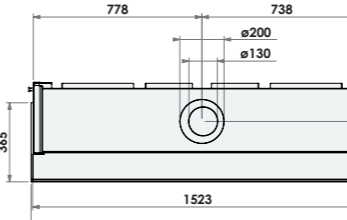
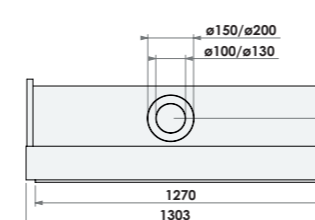
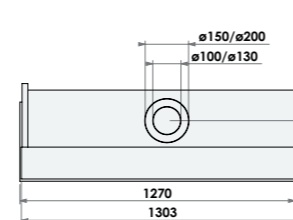
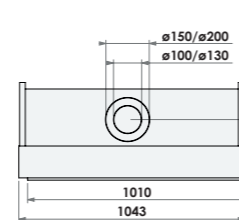
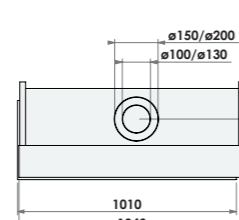
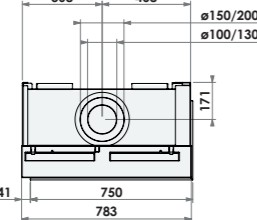
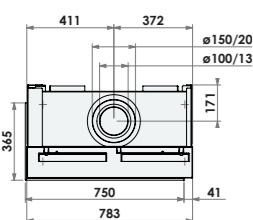
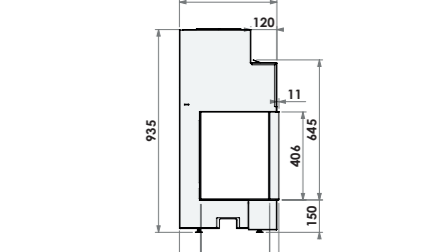
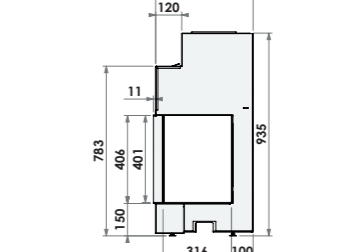
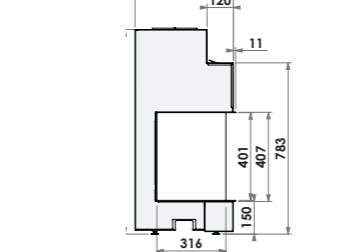
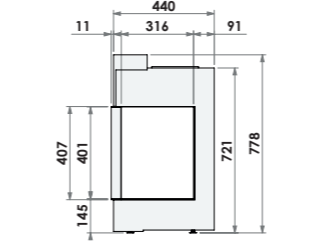
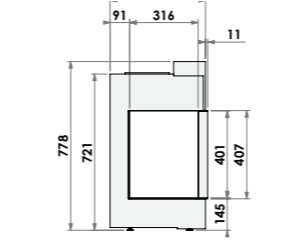
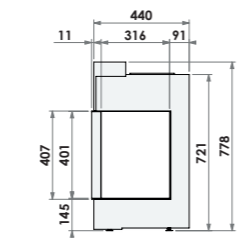
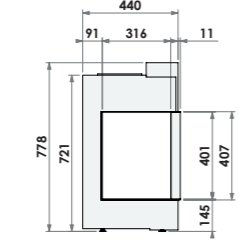
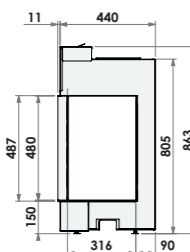
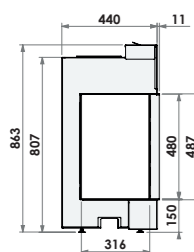
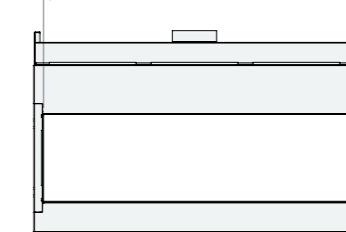
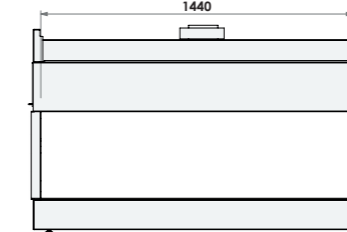
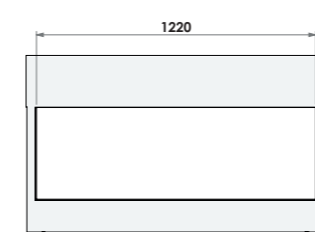
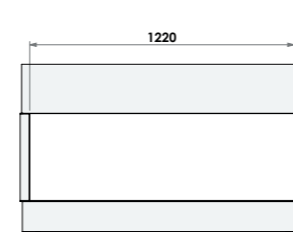
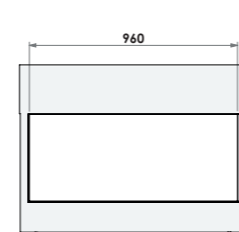
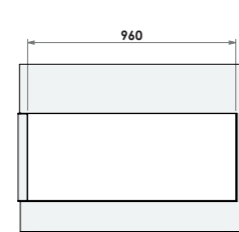
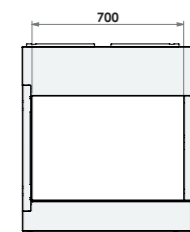
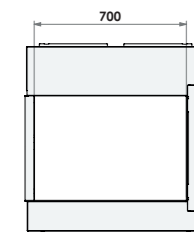



Maatschetsen

Dessins techniques | Dimension drawings | Disegni dimensionali

Corner Bell XXL R

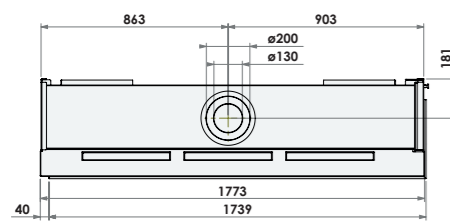
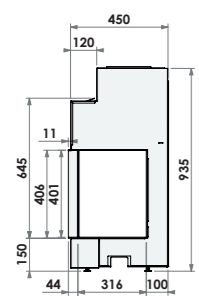
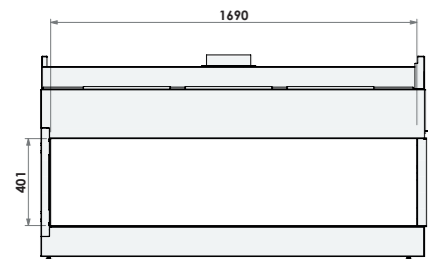

Corner Bell Topsham L

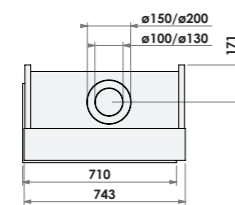
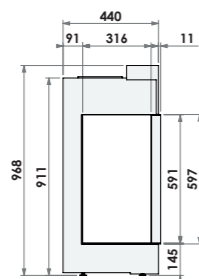
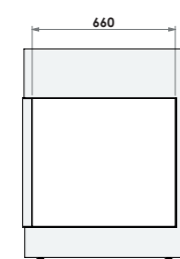

Corner Bell Topsham R

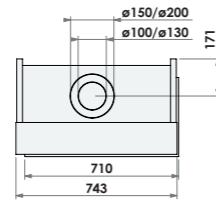
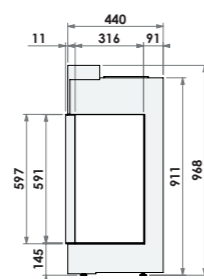
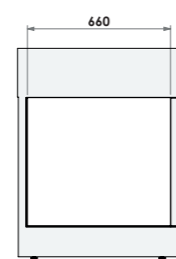

Corner Bell Derby L

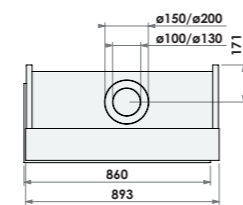
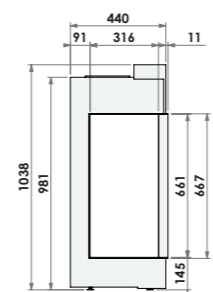
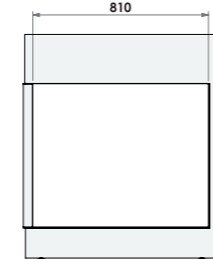

Corner Bell Derby R

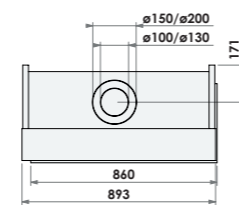
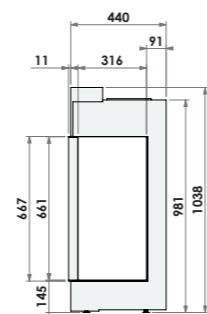
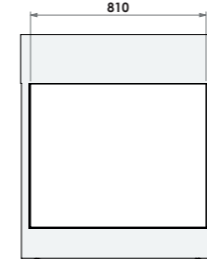

Corner Bell York L

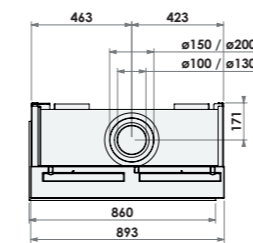
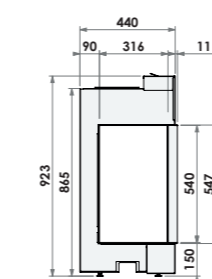
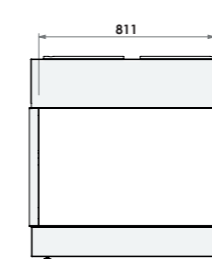

Corner Bell York R

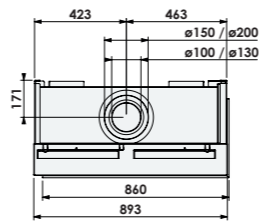
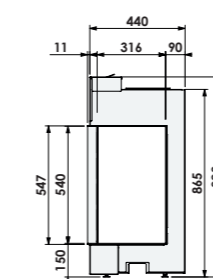
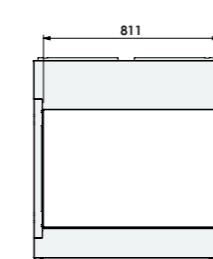

Driezijdige haarden

Appareils à trois faces | Three-sided fireplaces | Camini trifacciali

- Vuur in drievoud. Met z'n allen rond de haard dankzij een perfect zicht op het vuur vanuit alle hoeken.
- Du feu en triple. Installez-vous tous autour du feu grâce à une vue parfaite sur les flammes de chaque angle.
- Fire in triplicate. Everyone can sit around the fireplace and have a perfect view from all angles.
- Il fuoco al cubo. Grazie alla perfetta visuale sul fuoco da qualsiasi angolazione il camino diventerà il fulcro della casa intorno.



View Bell Small	58
View Bell Medium	59
View Bell Large	61
View Bell XL	62
View Bell XXL	63
View Bell Vertical	65
View Bell Topsham	66
View Bell Derby	67
View Bell York	69

Smart Bell Panorama 45/45	70
Smart Bell Panorama 45/59	70
Smart Bell Panorama 73/52	71

Overzicht uitvoeringen

Vue d'ensemble des versions | Overview of versions | Panoramica delle versioni

Originall Bell serie

View Bell

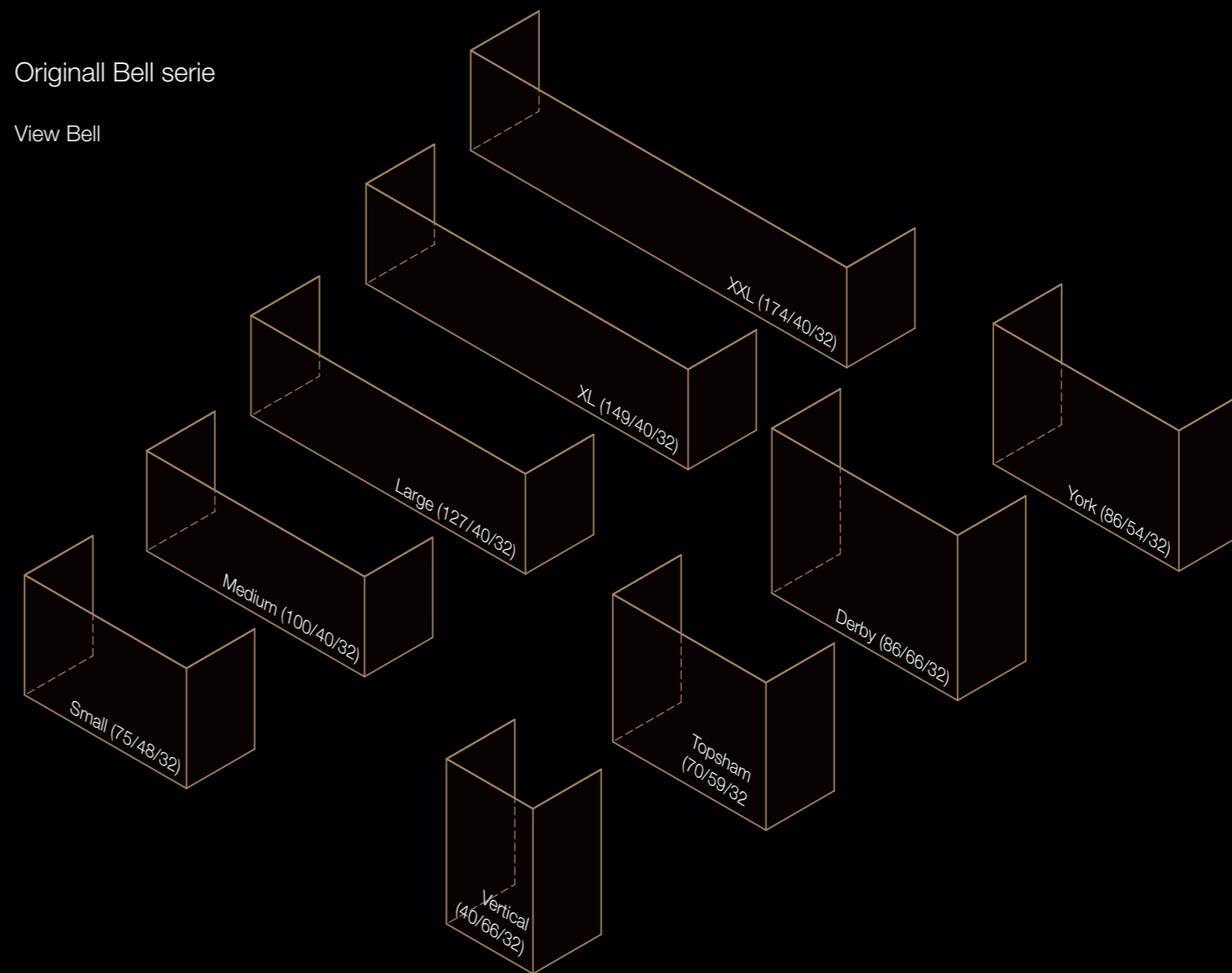

Smart Bell serie

Panorama

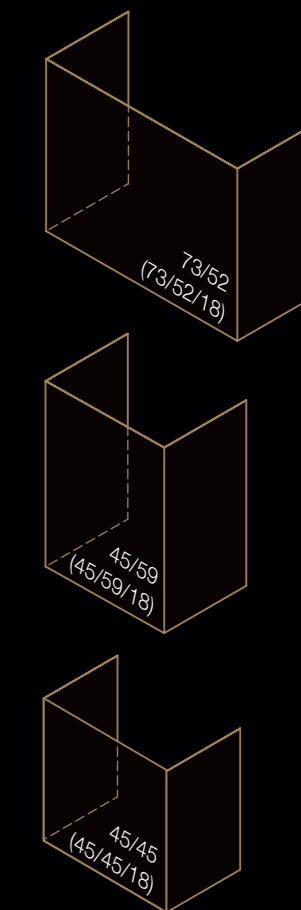

View Bell



Kader: Hidden Door +10 cm | Brander: Centre Fire

- ORIGINAL BELL SERIE
- P98
- PLC P105-108
- P110
- P111
- P112-114
- P104
- P104
- P103
- P73



Kader: Hidden Door +10 cm | Brander: Centre Fire

View Bell



ORIGINAL BELL
SERIE

P.98



P.105-106



P.110



P.111



P.112-114



P.104



P.104



P.103



P.73



View Bell

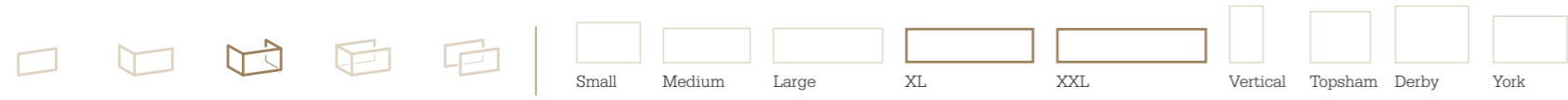

Kader: Hidden Door | Brander: Centre Fire

- ORIGINAL BELL SERIE
P.98
- LC
P.105-106
- P.110
- P.111
- P.112-114
- P.104
- P.104
- P.103
- P.74



Kader: Hidden Door | Brander: Centre Fire

View Bell



ORIGINAL BELL
SERIE
P.98





Kader: Hidden Door | Brander: Premium Fire

View Bell



A

Kader: Hidden Door +10 cm | Brander: Line Fire

- ORIGINAL BELL
SERIE
P.98
-  PLC
P.105-108
-  P.110
-  P.111
-  P.112-114
-  P.104
-  P.104
-  P.103
-  P.75

View Bell



ORIGINAL BELL
SERIE
P.98

PLC
P.105-108

P.110

P.111

P.112-114

P.104

P.104

P.103

P.75



A

Kader: Hidden Door +10 cm | Brander: Premium Fire

Smart Bell Panorama



A

Brander: MagniFire



SMART BELL
SERIE
P98

P107

P110

P111

P104

P104

P103

P72



B

Hidden Door | Brander: MagniFire



Maatschetsen

Dessins techniques | Dimension drawings | Disegni dimensionali

Smart Bell Panorama 45/45

Smart Bell Panorama 45/59

Smart Bell Panorama 73/52

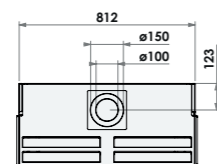
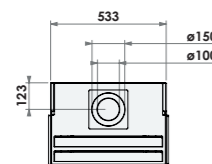
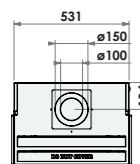
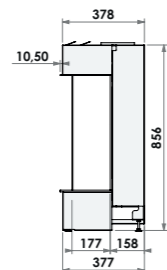
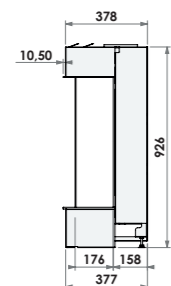
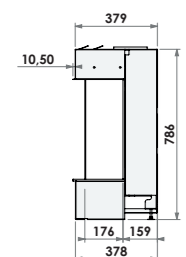
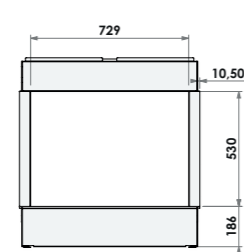
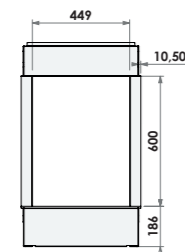
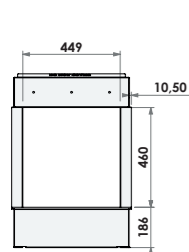

View Bell Small

View Bell Medium

View Bell Large

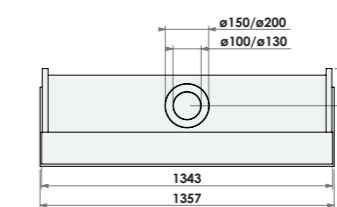
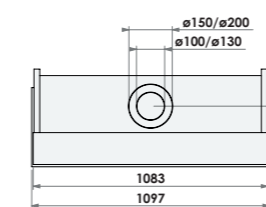
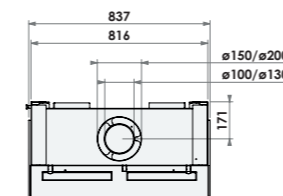
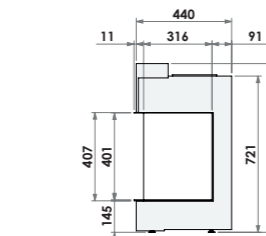
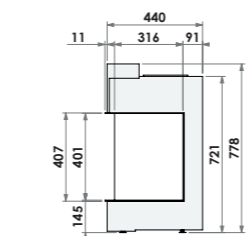
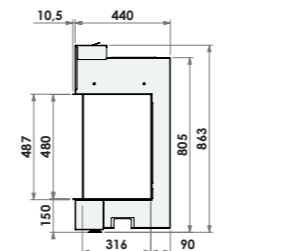
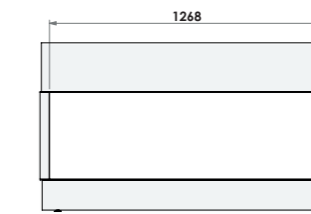
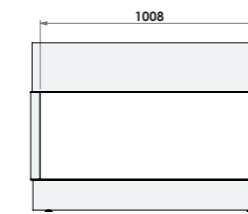
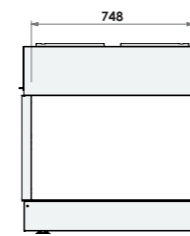



Maatschetsen

Dessins techniques | Dimension drawings | Disegni dimensionali

View Bell XL



View Bell XXL

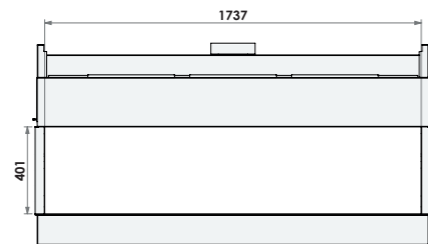

View Bell Vertical



View Bell Topsham

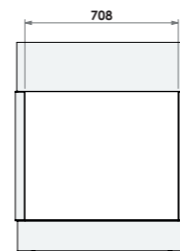

View Bell Derby

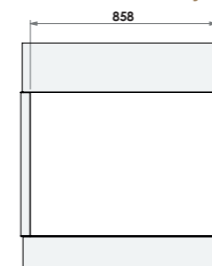

View Bell York

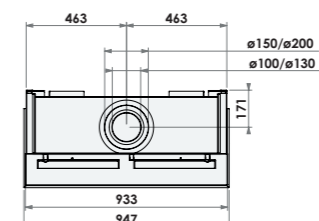
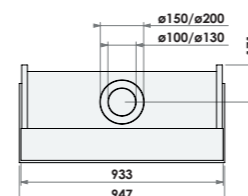
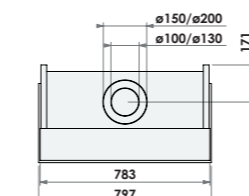
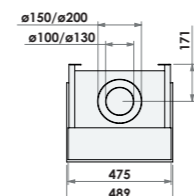
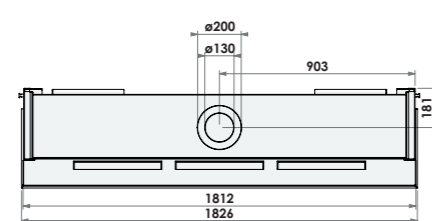
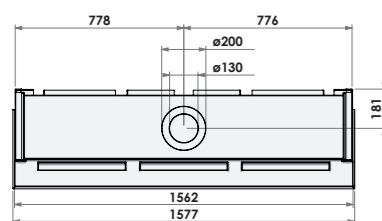
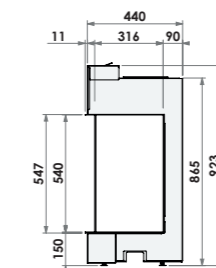
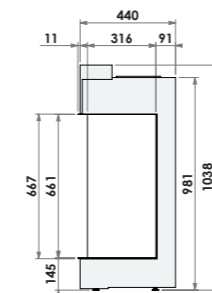
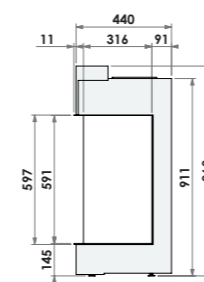
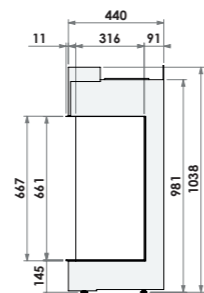
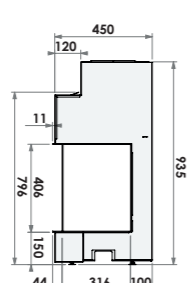
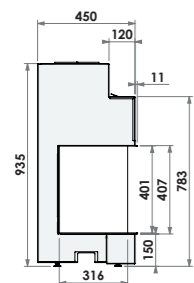
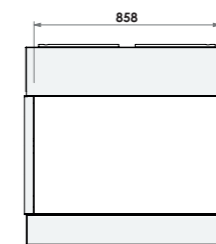

Room Dividers

Room Dividers | Room Dividers | Room Divider

- Met deze markante blikvanger verdeel je de ruimte en kun je vanuit verschillende hoeken van het vuur genieten.
- Avec cet appareil qui attire tous les regards, divisez la pièce et profitez du feu à partir d'angles différents.
- The remarkable eye catcher divides your room and you can enjoy the fire from various angles.
- Dividete lo spazio con questo pezzo d'arredamento attraente e godete il fuoco da ogni angolo della vostra casa.



Room Divider Medium	78
Room Divider Medium links / rechts	80
Room Divider Large	79
Room Divider Large links / rechts	81

Overzicht uitvoeringen

Vue d'ensemble des versions | Overview of versions | Panoramica delle versioni

Room Divider serie

Large

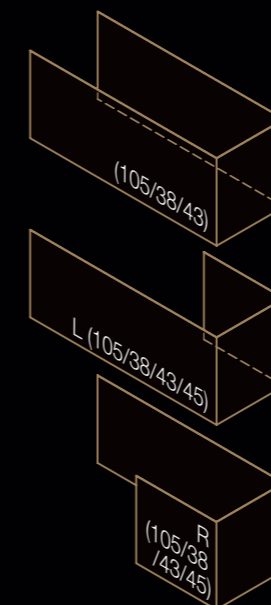

Medium





Kader: Hidden Door | Brander: MagniFire Flow

Room Divider



Kader: Hidden Door +10 cm | Brander: Centre Fire

- ORIGINAL BELL
SERIE

P-98
- 
LCM

P-105-107
- 
P-110
- 
P-111
- 
P-112-114
- 
P-104
- 
P-104
- 
P-103
- 
P-82

Room Divider



- ORIGINAL BELL SERIE P.98
- LCM P.105-107
- P.110
- P.111
- P.112-114
- P.104
- P.104
- P.103
- P.83





Maatschetsen

Dessins techniques | Dimension drawings | Disegni dimensionali

Room Divider Medium

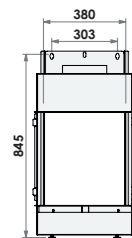

Room Divider Medium L

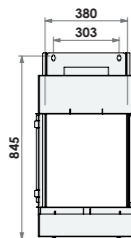

Room Divider Medium R

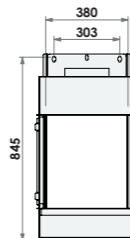

Room Divider Large

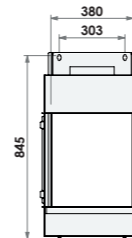

Room Divider Large L

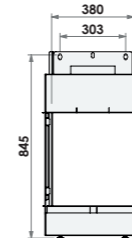

Room Divider Large R

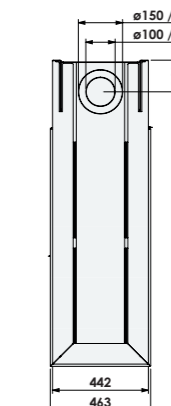
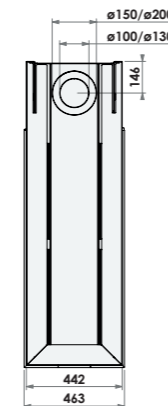
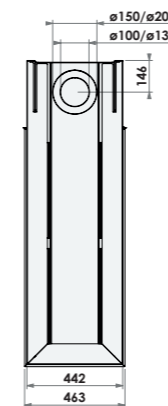
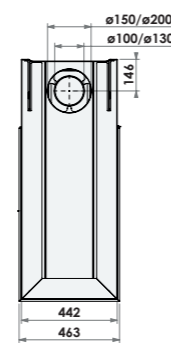
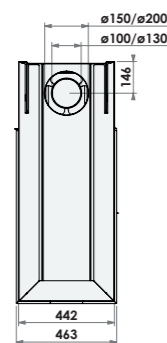
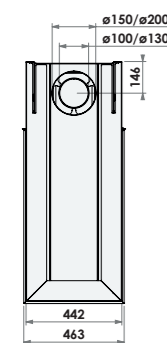
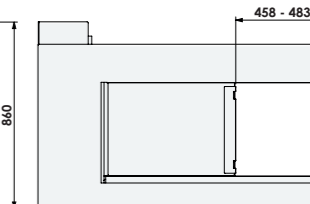
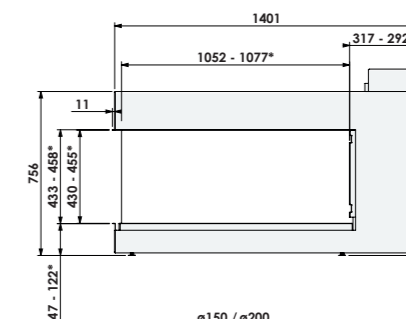
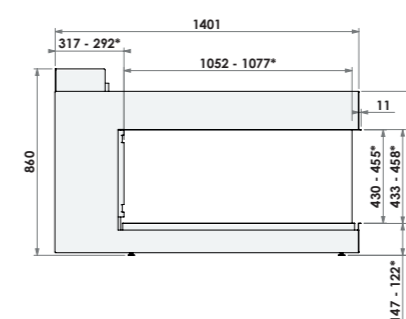
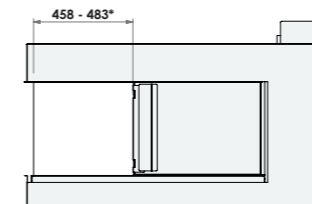
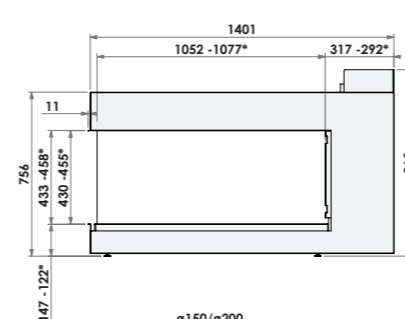
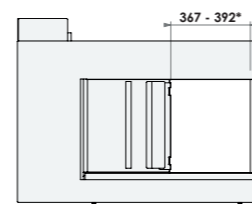
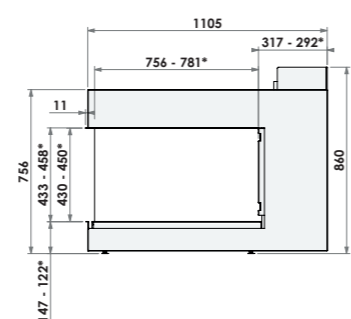
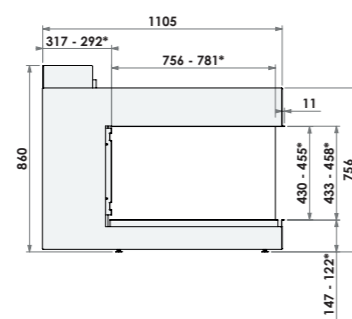
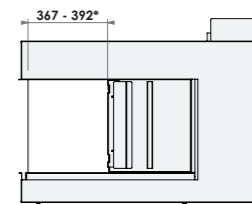
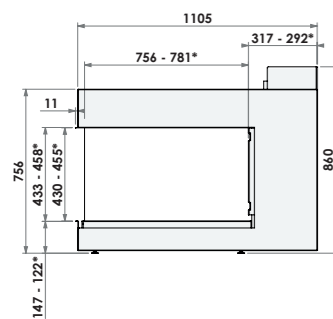
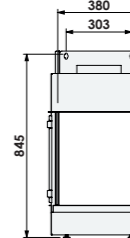

* = adjustable

* = adjustable

Tunnel haarden

Foyers tunnel | Tunnel fireplaces | Camini tunnel

- Dit is genieten van twee kanten. Deze tunnelvormige haarden geven nóg meer zicht op het vuur.
- Pour en profiter de deux côtés. Ces appareils tunnel offre une vue encore plus large sur les flammes.
- This is enjoyment from two sides. The tunnel-shaped fireplaces provide an even better view of the fire.
- Godersi il fuoco da più punti di vista: ecco l'essenza di questi camini. Questi camini a tunnel offrono una visuale ancora più ampia del fuoco.



Horizon Bell Small Tunnel	86
Horizon Bell Large Tunnel	87
Vertical Bell Small Tunnel	88
Vertical Bell Medium Tunnel	89
Derby Large Tunnel	91

Overzicht uitvoeringen

Vue d'ensemble des versions | Overview of versions | Panoramica delle versioni

Original Bell serie

Horizon Bell Tunnel

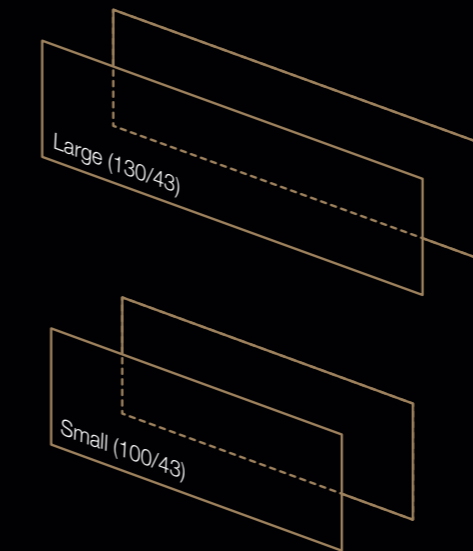

Vertical Bell Tunnel

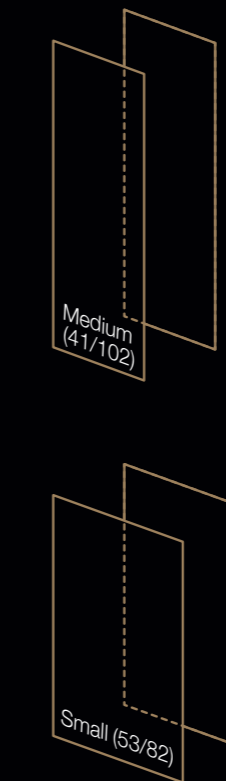

Derby Tunnel

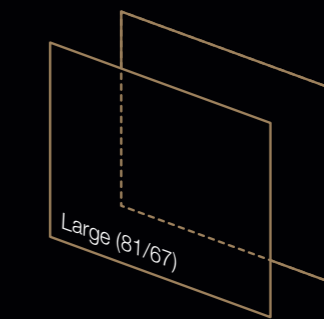

Tunnel haarden



Kader: Hidden Door | Brander: Line Fire

ORIGINAL BELL
SERIE
P.98



P.105-106



P.110



P.111



P.112-114



P.104



P.104



P.103



P.98



A

Kader: Hidden Door +7 cm | Brander: Centre Fire



Kader: Floating Frame | Brander: Line Fire

Tunnel haarden

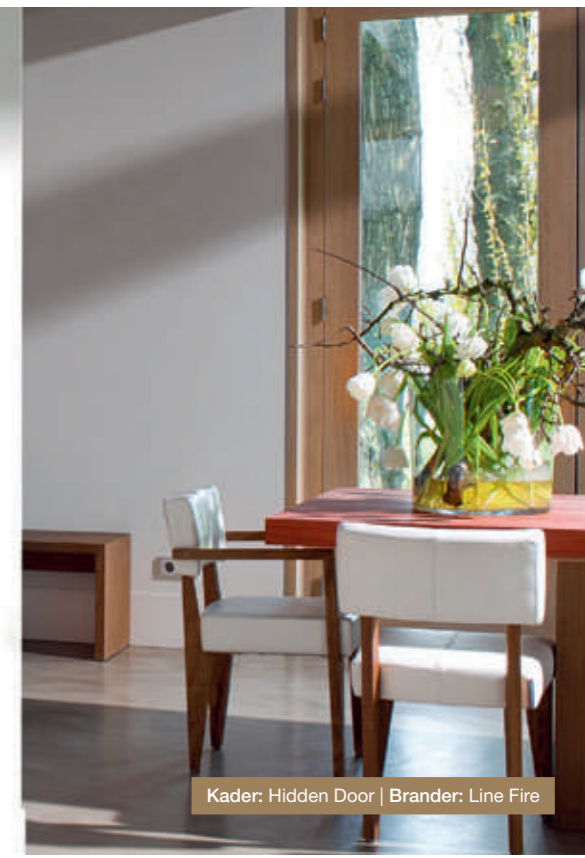

Kader: Hidden Door | Brander: Line Fire

- ORIGINAL BELL SERIE
P.98
- LC
P.105-106
- P.110
- P.111
- P.112-114
- P.104
- P.104
- P.103
- P.92-93

Tunnel haarden



ORIGINAL BELL
SERIE
P.98





Maatschetsen

Dessins techniques | Dimension drawings | Disegni dimensionali

Horizon Bell Small Tunnel

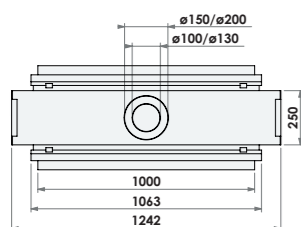
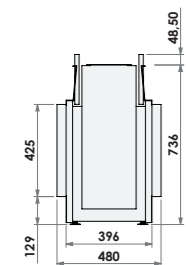
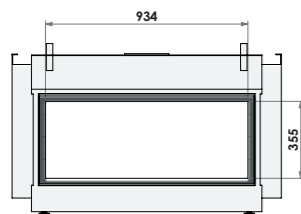

Horizon Bell Large Tunnel

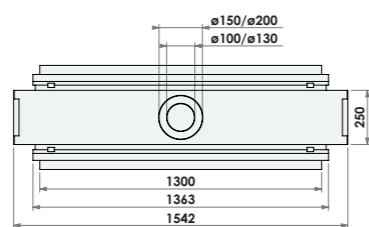
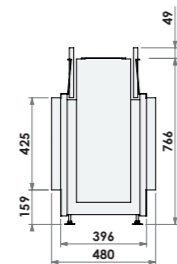

Vertical Bell Small Tunnel

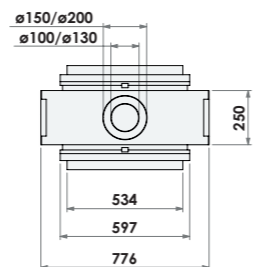
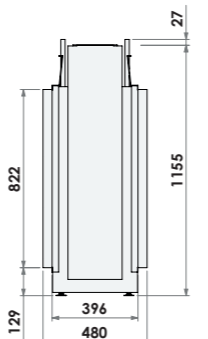
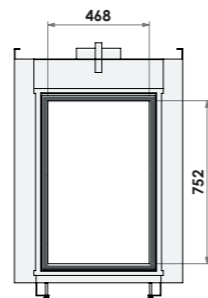

Vertical Bell Medium Tunnel

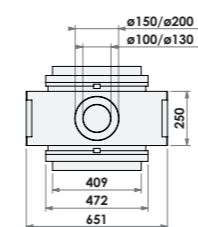
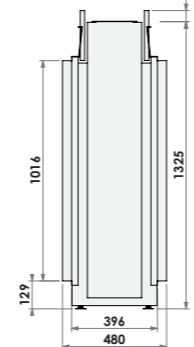
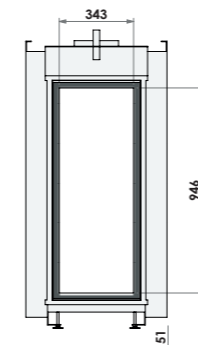

Derby Large Tunnel

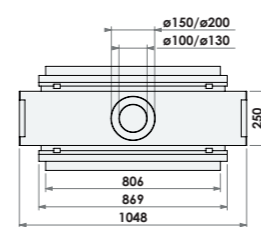
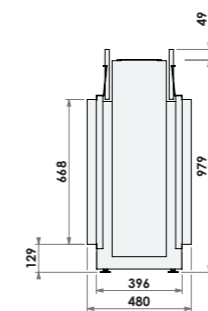
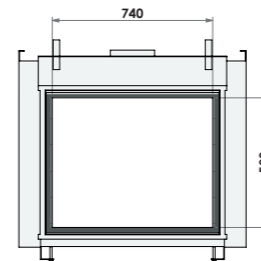

Product overzicht

Vue d'ensemble des produits |
Product overview |
Panoramica dei prodotti

	Fronthaarden				Frame	Double burner	Premium fire / energy efficiency class	Line fire / energy efficiency class	Centre fire / energy efficiency class	MagniFire / energy efficiency class	Interior	Mood lighting (electrical illumination)	standard	Weight	kg. approx.	Burner decoration	wood logs	grey stones	white marble shingles	Bellfires WiFi module	option	Output (kW)	natural gas (min-max)	Gas rate	natural gas (m³/hr)	propane (gr/hr)	Combustion system	balanced flue	Gas flue outlet / air supply	Ø (mm)
Derby Small							A	B	B		•	•	•	80	•	•	•				•	2-7	1,08	670					100-150/130-200	
Derby Large							A	A	A		•	•	•	98	•	•	•				•	2-8	1,21	670					100-150/130-200	
Topsham Small								B	B		•	•	•	70	•	•	•				•	2-7	0,98	670					100-150/130-200	
Topsham Large							A	A	A		•	•	•	89	•	•	•				•	2-8	1,18	670					100-150/130-200	
York Small							A	B	B		•	•	•	89	•	•	•				•	2-8	1,18	670					100-150/130-200	
York Large							A	B	B		•	•	•	126	•	•	•				•	2-10	1,40	670					100-150/130-200	
Horizon Bell XS							A	A	A		•	•	•	80	•	•	•				•	2-6	0,95	670					100-150/130-200	
Horizon Bell Small							A	A	A		•	•	•	98	•	•	•				•	2-7	1,10	670					100-150/130-200	
Horizon Bell Medium							A	A	A		•	•	•	112	•	•	•				•	2-8	1,21	750					100-150/130-200	
Horizon Bell Large							A	A	A		•	•	•	124	•	•	•				•	2-9	1,30	750					100-150/130-200	
Horizon Bell XL							A	A	A		•	•	•	132	•	•	•				•	2-10	1,41	860					100-150/130-200	
Horizon Bell XXL							B	B	B		•	•	•	156	•	•	•				•	2-12	1,60	860					130-200	
Vertical Bell Small							B	B	B		•	•	•	95	•	•	•				•	2-7	1,05	670					100-150/130-200	
Vertical Bell Medium							A	A	A		•	•	•	96	•	•	•				•	2-7	1,05	610					100-150/130-200	
Smart Bell 45/60		•	•	•	•				A		•	•		50	•						•	2-4	0,52	360					100-150	
Smart Bell 55/55		•	•	•	•				A		•	•		49	•						•	2-4	0,51	350					100-150	
Smart Bell 55/60		•	•	•	•				B		•	•		54	•						•	2-5	0,62	400					100-150	
Smart Bell 65/55		•	•	•	•				B		•	•		56	•						•	2-5	0,57	380					100-150	
Smart Bell 65/60		•	•	•	•				B		•	•		61	•						•	3-5	0,66	440					100-150	
Smart Bell 75/55		•	•	•	•				A		•	•		63	•						•	2-5	0,64	390					100-150	
Smart Bell 75/60		•	•	•	•				A		•	•		67	•						•	3-6	0,71	440					100-150	

Type of gas ³	natural gas	propane	butane
Convection casing	standard	option	option
Convection fan system	option	option	option
Flue outlet	concentric	concentric	concentric

¹ Not possible with propane/ butane.
² Mood lighting comes standard when the appliance is equipped with a Premium Fire double burner or with a MagniFire double burner.
³ Type of gas and burner decoration influence flame appearance (height).

The technical values in this table are indicative, and may differ per country and gas pressure.
 For an exact representation please refer to the installation manual.

¹ Pas possible au propane/butane.
² L'éclairage d'ambiance est standard lorsque l'appareil est équipé d'un double brûleur Premium Fire ou MagniFire.
³ Le type de gaz et la décoration de brûleur influencent l'esthétique et la hauteur de la flamme.

Les valeurs techniques dans ce tableau sont indicatives et peuvent différer selon les pays et les pressions de gaz.
 Pour connaître sa valeur exacte, vous pouvez consulter le manuel d'installation.

Product overzicht

Vue d'ensemble des produits |
Product overview |
Panoramica dei prodotti

Fronthaarden (vervolg)

Model	1	2	3	4	5	6	7	8	9	10	11	12
Smart Bell 75/70		•	•	•	•	•						
Smart Bell 75/80	•	•	•	•	•	•						
Smart Bell 80/60		•	•	•	•	•						
Smart Bell 80/70	•	•	•	•	•	•						
Smart Bell 80/80		•	•	•	•	•						
Smart Bell 90/70	•	•	•	•	•	•						
Smart Bell 90/80		•	•	•	•	•						

Tweezijdige haarden

Model	1	2	3	4	5	6	7	8	9	10	11	12
Corner Bell Small							•			•		
Corner Bell Medium							•			•		
Corner Bell Large							•			•		
Corner Bell XL							•			•		
Corner Bell XXL							•			•		
Corner Bell Derby							•			•		
Corner Bell Topsham							•			•		
Corner Bell York							•			•		

Cadres

Sans cadre												
Cadre encastrable												
Cadre classique 35 mm												
Cadre classique 52 mm												
Cadre de profondeur 15 mm												
Cadre de profondeur 50 mm												
Hidden Door												
Hidden Door +7 cm												
Hidden Door +10 cm												
Floating Frame												

Double brûleurs

Premium Fire / énergie efficacité class												
Line Fire / énergie efficacité class												
Centre Fire / énergie efficacité class												
MagniFire / énergie efficacité class												

Intérieurs

Lamelles en acier												
Fond lisse												
Miroir céramique noir												
Industrial interior												

Éclairage d'ambiance

Standard												
----------	--	--	--	--	--	--	--	--	--	--	--	--

Poids

kg												
----	--	--	--	--	--	--	--	--	--	--	--	--

Décorations de brûleur

Bûches céramique												
Cailloux gris												
Cailloux blancs												

Bellfires Module Wi-Fi

Option												
--------	--	--	--	--	--	--	--	--	--	--	--	--

Puissance (KW)

Gaz Naturel (min-max)												
-----------------------	--	--	--	--	--	--	--	--	--	--	--	--

Consommation

Gaz naturel (m ³ /hr)												
----------------------------------	--	--	--	--	--	--	--	--	--	--	--	--

Propane (gr/hr)

--	--	--	--	--	--	--	--	--	--	--	--	--

Système de combustion

Ventouse												
----------	--	--	--	--	--	--	--	--	--	--	--	--

Sortie de conduit de gaz

--	--	--	--	--	--	--	--	--	--	--	--	--

Ø (mm)

Frame

frameless												
built-in frame												
classic frame 35 mm												
classic frame 52 mm												
insert frame 15 mm												
insert frame 50 mm												
Hidden Door												
Hidden Door +7 cm												
Hidden Door +10 cm												
Floating Frame												

Double burner

Premium fire / energy efficiency class												
Line fire / energy efficiency class												
Centre fire / energy efficiency class												
MagniFire / energy efficiency class												

Interior

steel panels												
plain background												
ceramic black mirror interior												
industrial interior												

Mood lighting (electrical illumination)

standard												
----------	--	--	--	--	--	--	--	--	--	--	--	--

Weight

kg. approx.												
-------------	--	--	--	--	--	--	--	--	--	--	--	--

Burner decoration

wood logs												
grey stones												
white marble shingles												

Bellfires WiFi module

option												
--------	--	--	--	--	--	--	--	--	--	--	--	--

Output (kW)

natural gas (min-max)												
-----------------------	--	--	--	--	--	--	--	--	--	--	--	--

Gas rate

natural gas (m ³ /hr)												
----------------------------------	--	--	--	--	--	--	--	--	--	--	--	--

propane (gr/hr)

--	--	--	--	--	--	--	--	--	--	--	--	--

Combustion system

balanced flue												
---------------	--	--	--	--	--	--	--	--	--	--	--	--

Gas flue outlet / air supply

--	--	--	--	--	--	--	--	--	--	--	--	--

Ø (mm)

Type of gas ³

Gaz Naturel												
Propane												
Butane												

Calaise de convection

Standard												
Option												

Ventilateur de convection

Option												
Option												

Raccordement du conduit

Concentrique												
--------------	--	--	--	--	--	--	--	--	--	--	--	--

Type of gas ³

natural gas												
propane												
butane												

Convection casing

standard												
option												

Convection fan system

option												
option												

Flue outlet

concentric												
------------	--	--	--	--	--	--	--	--	--	--	--	--

¹ Not possible with propane/ butane.

² Mood lighting comes standard when the appliance is equipped with a Premium Fire double burner or with a MagniFire double burner.

³ Type of gas and burner decoration influence flame appearance (height).

The technical values in this table are indicative, and may differ per country and gas pressure.

For an exact representation please refer to the installation manual.

¹ Pas possible au propane/butane.

² L'éclairage d'ambiance est standard lorsque l'appareil est équipé d'un double brûleur Premium Fire ou MagniFire.

³ Le type de gaz et la décoration de brûleur influencent l'esthétique et la hauteur de la flamme.

Les valeurs techniques dans ce tableau sont indicatives et peuvent différer selon les pays et les pressions de gaz.

Pour connaître sa valeur exacte, vous pouvez consulter le manuel d'installation.

Original Bell serie

Série Original Bell | Original Bell series | Serie Original Bell

- Meer installatiemogelijkheden door rookgasafvoer in zowel 100/150 en 130/200.
 - Plus de possibilités d'installation grâce à l'évacuation des fumées dans les deux diamètres 100/150 et 130/200.
 - Flue connections of 100/150 and 130/200 provide more installation possibilities.
 - Maggiori possibilità di installazione grazie tubo di scarico fumi da 100/150 e 130/200.

- Gesloten systeem, dus een hoger rendement.
 - Système à ventouse, pour un rendement plus élevé.
 - Closed system, therefore a higher yield.
 - Sistema chiuso, rendimento più alto.

- Optimaal zicht op het vuur, met naar keuze gepolijst of ontspiegeld glas.
 - Vue optimale sur le feu, avec vitre polie ou antireflet au choix.
 - Enhanced view of the fire with a choice of polished or non-reflective glass.
 - Visuale sul fuoco ottimale, con scelta tra vetro di serie o antiriflesso.

- Passend in ieder interieur met keuze uit diverse kaders.
 - Se marie avec chaque intérieur avec un choix de différents cadres.
 - Suitable for every interior with a choice of various frames.
 - Adattabile a qualsiasi arredamento grazie alla possibilità di scelta tra diverse cornici.

- Maak je haard persoonlijk, met diverse keuzes in interieur en brander decoratie.
 - Personnalisez votre appareil, avec plusieurs choix d'intérieurs et de décorations de brûleur.
 - Give your fireplace a personal touch with various choices for the interior and burner decoration.
 - Personalizzate il vostro camino con le svariate possibilità di scelta del rivestimento interno e della decorazione dei bruciatori.

- Veilig en gemakkelijk in gebruik, door het gepatenteerde deurmechanisme.
 - Utilisation sûre et facile grâce au mécanisme de porte breveté.
 - Patented door mechanism makes it safe and easy to use.
 - Sicuro e di facile utilizzo grazie allo sportello con meccanismo brevettato.

- Altijd een haard die past, dankzij de vele maatvarianten.
 - Il y a toujours un appareil adapté grâce aux nombreuses dimensions.
 - There is always a suitable fireplace thanks to the many sizes available.
 - Un camino che calza a pennello in ogni ambiente grazie alle diverse misure disponibili.

- Gebruiksgemak ten top, bediening middels handzender of optionele App.
 - Utilisation simplissime par une télécommande ou une application en option.
 - Super easy to use, operates by remote control or an optional App.
 - Comodità d'uso superiore con la gestione tramite telecomando o app opzionale.

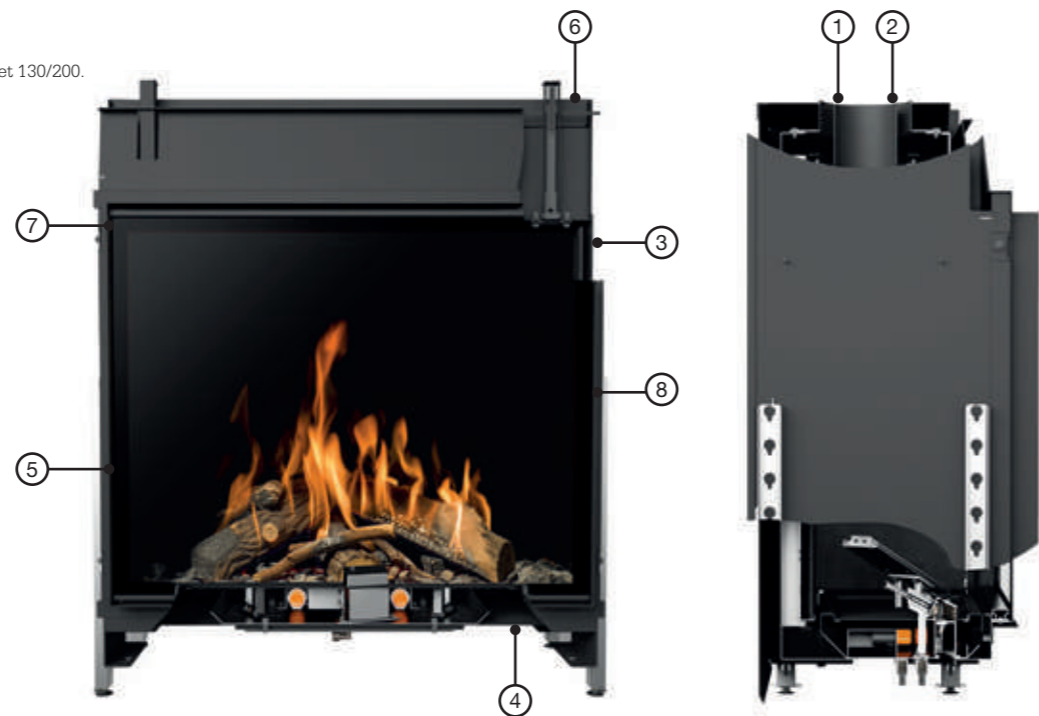

Smart Bell serie

Série Smart Bell | Smart Bell series | Serie Smart Bell

- Door de concentrische rookgasafvoer van 100/150 ook perfect geschikt voor renovatie.
 - Grâce au conduit concentrique de 100/150, ces appareils conviennent parfaitement pour la rénovation.
 - The 100/150 flue connection allows installation into existing chimneys with the flex kit.
 - Con il tubo di scarico fumi da 100/150 è perfetto anche per interventi di ristrutturazione.

- Gesloten systeem, dus een hoger rendement.
 - Système à ventouse, pour un rendement plus élevé.
 - Closed system, therefore a higher yield.
 - Sistema chiuso, rendimento più alto.

- Een prachtig vuurbeeld, dankzij de standaard schakelbare MagniFire of Premium Fire.
 - Une magnifique vue sur les flammes grâce au MagniFire ou Premium Fire modulable et standard.
 - An amazing display of fire thanks to the standard switchable MagniFire or Premium Fire.
 - Un fuoco dall'aspetto incantevole grazie al MagniFire commutabile standard o al Premium Fire.

- De sfeerverlichting geeft extra vuurbeleving.
 - L'éclairage d'ambiance optimise l'expérience du feu.
 - The ambiance lighting provides added enjoyment of the fire.
 - L'illuminazione d'ambiente per un'esperienza ancora più coinvolgente.

- De minimale diepte van 35 cm, biedt extra inbouwvrijheid.
 - La profondeur minimale de 35 cm offre une liberté d'encastrement supplémentaire.
 - The minimum depth of 35 cm offers additional freedom in building it in.
 - La profondità minima di 35 cm offre maggiore libertà di incasso.

- Eenvoudig in onderhoud, alle techniek is van voren te bereiken.
 - Facile à entretenir, toute la technique étant accessible par l'avant.
 - Easy to maintain, all the technical parts can be reached from the front side.
 - Di facile manutenzione dato che tutti i comandi sono accessibili dalla parte anteriore.

- Extra stookcomfort met de optionele convectieventilator.*
 - Confort supplémentaire avec le ventilateur de convection en option.*
 - Additional burning comfort with the optional convection fan.*
 - Calore molto confortevole grazie al ventilatore di convezione.*

- Passend in ieder interieur met keuze uit diverse kaders.
 - Se marie avec chaque intérieur avec un choix de différents cadres.
 - Suitable for every interior with a choice of various frames.
 - Adattabile a qualsiasi arredamento grazie alla possibilità di scelta tra diverse cornici.

- Gebruiksgemak ten top, bediening middels handzender of optionele App.
 - Utilisation simplissime par une télécommande ou une application en option.
 - Super easy to use, operates by remote control or an optional App.
 - Comodità d'uso superiore con la gestione tramite telecomando o app opzionale.

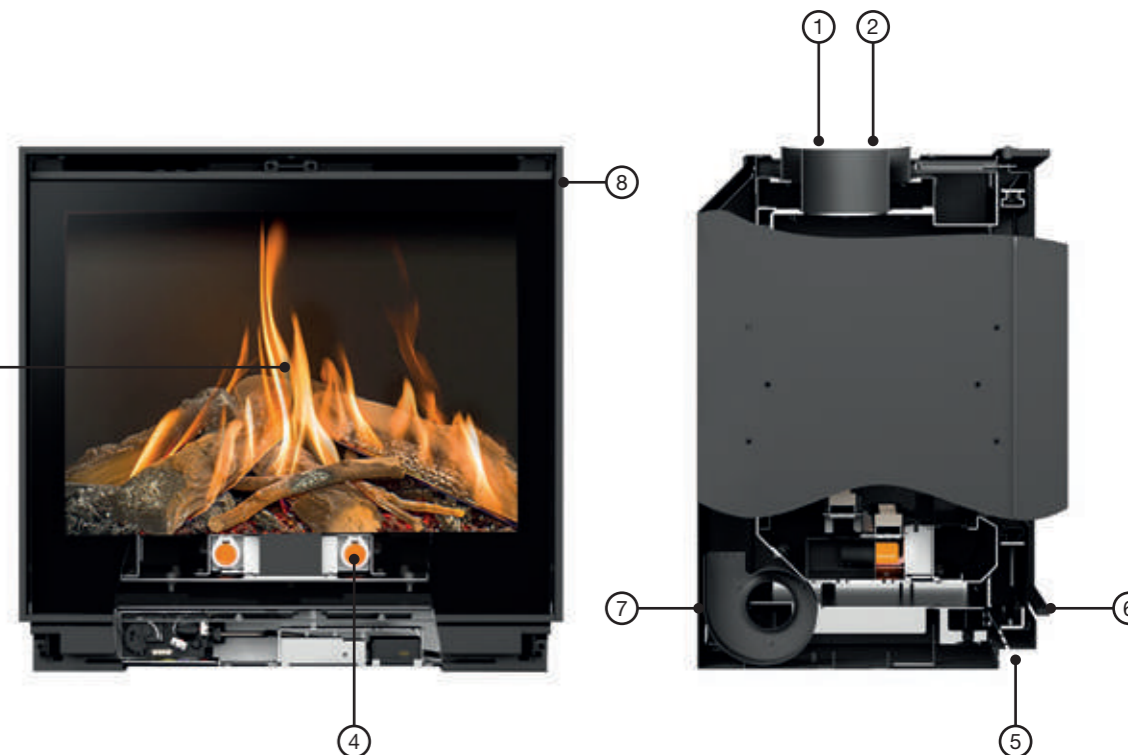

* Let op: 5,5 cm extra inbouwdiepte. | Veuillez noter: profondeur d'installation supplémentaire de 5,5 cm. | Note: 5,5 cm extra installation depth. | Nota: profondità di installazione extra di 5,5 cm.



Renovatie

Rénovation | Renovation | Ristrutturazioni

■ Zeer geschikt bij renovatie

Speciaal voor de renovatiemarkt levert Bellfires een aantal zogeheten inzethaarden. Deze haarden passen door hun afmetingen en kadervarianten in praktisch elke bestaande situatie. Dit wordt mede mogelijk gemaakt door allerlei technische snufjes. Zo zijn ze van binnenuit aan te sluiten en hebben ze geen bedieningsluikje nodig. De maatvoering van deze toestellen is speciaal afgestemd op de meest voorkomende maten van bestaande open haarden. Dit geeft nieuw vuur in een bestaande situatie. Je herkent deze inzethaarden aan het “extra-geschikt-voor-renovatie” logo.

■ Particulièrement adaptés à la rénovation

Spécialement pour le marché de la rénovation, Bellfires propose plusieurs inserts. Grâce à leurs dimensions et différents cadres, ces appareils s’adaptent pratiquement à chaque situation existante. Cela est également possible grâce à toutes sortes de gadgets techniques. C’est ainsi qu’ils peuvent être raccordés de l’intérieur et qu’aucune trappe d’accès n’est requise. Les dimensions de ces appareils sont spécialement adaptées aux tailles les plus courantes des âtres ouverts existants. Cela permet de créer un nouveau feu dans une situation existante. Ces inserts sont reconnaissables au logo “particulièrement adapté à la rénovation”.

■ Very suitable for renovation

Bellfires supplies a number of insert fireplaces specifically for the renovation market. Due to their dimensions and variety of frames, these fireplaces fit into practically any existing situation. This is also made possible by the use of all sorts of technical innovations. For example, they can be connected at the inside and they do not need a control hatch. The dimensions of these appliances are specifically coordinated to the most common dimensions of existing open fireplaces. This provides a new fire in an existing situation. You can recognise these insert fireplaces by the “extra-suited for renovation” logo.

■ Particolarmente adatto per interventi di ristrutturazione

Bellfires offre alcuni camini cosiddetti da inserto appositamente studiati per il settore delle ristrutturazioni. Questi camini, grazie alle loro dimensioni e varianti di cornici, si adattano a praticamente qualsiasi situazione esistente. Tutto ciò è possibile grazie alle ingegnose soluzioni adottate. Ad esempio è possibile collegare il caminetto dall’interno e non vi è necessità di un pannello di controllo. Le dimensioni di questi dispositivi sono appositamente studiate per rispettare le dimensioni più comuni dei camini aperti esistenti. In questo modo è possibile installare un apparecchio nuovo in una situazione esistente. È possibile riconoscere questi camini da inserto dal logo “particolarmente-adatto-per-ristrutturazioni”



Convectie ventilator

Ventilateur de convection | Convection fan | Ventilatore ambiente

■ Krachtige ventilator

Enkele van onze haarden kunnen optioneel voorzien worden van een krachtige ventilator die zorgt voor een snelle verspreiding van de warmte in de ruimte. Deze regelbare ventilator bevindt zich onder of in het toestel. Afhankelijk van het type haard kan deze ventilator uitgeschakeld worden.

■ Ventilateur puissant

Plusieurs de nos appareils peuvent être équipés en option d’un ventilateur puissant qui assure une diffusion rapide de la chaleur dans la pièce. Ce ventilateur réglable se trouve en dessous ou à l’intérieur de l’appareil. Selon le type d’appareil, ce ventilateur peut être éteint.

■ Powerful fan

Some of our fireplaces can be optionally equipped with a powerful fan system that ensures heat is spread rapidly throughout the room. This adjustable fan is located underneath or inside the appliance. Depending on the type of fireplace, this fan can be switched off.

■ Sistema di ventilazione potente

Alcuni dei nostri camini possono essere dotati come optional di una potente ventola che garantisce una rapida diffusione del calore nell’ambiente. La ventola regolabile si trova sotto o all’interno dell’apparecchio. In base al modello di camino, la ventola può anche essere spenta.



Gassoorten

Types de gaz | Gas types | Tipi di gas

■ Gassoorten

Al onze haarden zijn voorzien van de modernste techniek. Dat betekent dat ze over een prachtig, betoverend vuurbeeld beschikken en ook nog eens goed voorbereid zijn op de toekomst. Zo zijn al onze gashaarden gekeurd voor de nieuwste gassoorten. En daarnaast is het ook mogelijk om onze haarden van de ene naar de andere gassoort om te bouwen. Bijvoorbeeld van aardgas naar propaan.

Daarom zijn onze haarden dus niet alleen voorzien van het mooiste vuurbeeld maar ook nog eens toekomstbestendig. Heb je vragen over de verschillende mogelijkheden? Jouw dealer weet er alles van en vertelt hier graag meer over.

■ Types de gaz

Tous nos appareils intègrent des techniques dernier cri. Ils offrent donc non seulement une vue formidable et ensorcelante sur les flammes, mais sont également parfaitement parés pour l’avenir. C’est ainsi que tous nos appareils au gaz sont homologués pour les derniers types de gaz. De plus, il est également possible de transformer nos appareils d’un type de gaz à un autre. Par exemple du gaz naturel au propane ou vice versa.

Nos foyers offrent donc non seulement la plus jolie vue sur les flammes, mais résistent également à l’épreuve du temps. Vous avez des questions sur les différentes possibilités ? Votre revendeur se fera un plaisir de vous en dire plus.

■ Gas types

All our fireplaces feature the latest technology. This means that they provide a beautiful and magical fire display and they are manufactured with the future in mind. All our gas fireplaces are approved for the latest gas types. Furthermore, they can be refitted to switch from one type of gas to another e.g., from natural gas to propane.

That is why our fireplaces not only provide the nicest flame image, but they are also future-proof. Any questions about the various possibilities? Your dealer knows everything about our products and will be pleased to help you.

■ Tipi di gas

Tutti i nostri camini sono dotati delle più moderne tecnologie. Questo significa che oltre a sprigionare fiamme ammalianti restituendo un meraviglioso aspetto del fuoco, essi sono pronti ad accogliere le tecnologie del futuro. Infatti, i nostri camini a gas sono certificati per i più recenti tipi di gas. Inoltre è possibile adattare i nostri camini da un tipo di gas all’altro. Ad esempio da gas naturale a propano.

I nostri camini non hanno solo una fiamma affascinante ma dispongono anche di una tecnologia all’avanguardia. Volete conoscere in dettaglio le varie possibilità? Il vostro rivenditore sarà lieto di rispondere a tutte le domande.



Afstandsbediening en WiFi

Télécommande et Wi-Fi | Remote control and WiFi | Telecomando e WiFi

■ Al onze haarden zijn standaard uitgerust met de nieuwste generatie Symax afstandsbedieningen. Deze afstandsbedieningen bieden volop gebruiksgemak doordat elke functie een eigen knop heeft. Dit maakt het bedienen van je gashaard kinderlijk eenvoudig.

Je kunt eventueel ook kiezen voor een WiFi-module. Dan kun je de haard bedienen met behulp van je tablet of smartphone. Bij het gebruik kun je kiezen voor WiFi en een handzender of je kiest voor de puck. De puck is een vereenvoudigde afstandsbediening waarmee je in combinatie met de Bellfires-app alle functionaliteiten kunt bedienen.

■ Tous nos appareils sont équipés de série de la dernière génération de télécommandes Symax. Ces télécommandes sont très faciles à utiliser grâce au bouton spécifique attribué à chaque fonction. Ainsi, commander votre appareil au gaz devient un jeu d'enfant.

Vous pouvez éventuellement aussi opter pour un module Wi-Fi. Ainsi, vous pouvez commander l'appareil avec votre tablette ou smartphone. Pour l'utilisation, vous avez le choix entre le Wi-Fi avec émetteur manuel ou le puck. Le puck est une télécommande simplifiée vous permettant de commander toutes les fonctionnalités en combinaison avec l'application Bellfires.

■ All our fireplaces are standard equipped with the latest generation Symax remote controls. These remote controls are very easy to use because each function has its own button. This makes the operation of your gas fireplace very simple.

You may also opt for a WiFi module, which enables you to operate your fireplace using your tablet or smartphone. When selecting WiFi, you can choose either a remote control or a puck. The puck is a simplified remote control that offers all the functions when combined with the Bellfires-app.

■ Tutti i nostri camini hanno di serie i telecomandi Symax di ultima generazione. Questi telecomandi offrono una grande facilità di uso e di controllo grazie al fatto che ogni funzione ha un pulsante apposito. Questo rende il controllo del vostro camino a gas incredibilmente semplice.

E' disponibile anche un modulo WiFi. Che vi permetterà di gestire il camino direttamente dal vostro smartphone o tablet. Puoi scegliere di gestire il tuo camino tramite WiFi con telecomando o con "disco". Il "disco" è un telecomando semplificato con cui è possibile controllare tutte le funzioni in combinazione con l'applicazione Bellfires.



- Afstandsbediening en puck
- Télécommande et puck
- Remote control and puck
- Telecomando e disco

Overzicht schakelbare branders

Vue d'ensemble des brûleurs modulables | Overview of switchable burners | Panoramica bruciatori



Line Fire

■ Line Fire
Als je beide branders inschakelt geef je extra diepte en sfeer aan het vlambeeld. In de spaarstand brandt alleen de voorste brander, maar dan wél over de volledige breedte van de haard. Hiermee bespaar je op gasverbruik en heb je minder warmteafgifte.

■ Line Fire
Les deux brûleurs allumés confèrent une profondeur et une ambiance supplémentaires aux flammes. En position économique, il n'y a que le brûleur avant qui est actif, mais il l'est sur toute la largeur de l'appareil.

■ Line Fire
If you switch on both burners, you give the flame image extra depth and atmosphere. In the save position, only the front burner burns, but over the entire length of the fireplace. This saves on gas consumption and reduces the heat output.

■ Line Fire
Accendendo entrambi i bruciatori la fiamma ha una profondità maggiore ed una fiamma più intensa. In modalità risparmio energetico si accenderà solo il bruciatore frontale, ma le sue fiamme occuperanno tutta la larghezza del camino. Con questo sistema potrete risparmiare sul consumo di gas, ottenendo un minor rilascio di calore.



- Beide branders aan
- Les deux brûleurs allumés
- Both burners on
- Entrambi i bruciatori sono accesi



- In spaarstand; alleen voorste brander aan
- En position économique; seul le brûleur de devant est allumé
- In the power saving mode; only the front burner on
- Nella modalità risparmio energetico, solo il bruciatore frontale è acceso

Overzicht schakelbare branders

Vue d'ensemble des brûleurs modulables | Overview of switchable burners | Panoramica bruciatori



Centre Fire

■ Centre Fire

Bij dit type varieer je het vuurbeeld in de breedte. Twee branders geven de gashaard een warm vuur over de volledige breedte van de haard. In de spaarstand brandt het vuur alleen in het midden van de haard. Hiermee bespaar je op gasverbruik en heb je minder warmteafgifte.

■ Centre Fire

De cette manière, le feu peut être réglé en largeur. Avec deux brûleurs, l'appareil au gaz offre un feu chaleureux sur toute la largeur de l'appareil. En position économique, seul le brûleur du milieu est allumé.

■ Centre Fire

This type allows you to vary your flame image in the width. Two burners give the gas fireplace a warm fire over the entire width of the fireplace. In the save position, the fire burns only in the middle of the fireplace. This saves on gas consumption and reduces the heat output.

■ Centre Fire

Con questo tipo potete regolare l'ampiezza dell'aspetto del fuoco. Due bruciatori danno vita ad un fuoco caldo e vivace su tutta la larghezza del camino a gas. In modalità risparmio energetico il fuoco occuperà solo il centro del camino. Con questo sistema potrete risparmiare sul consumo di gas, ottenendo un minor rilascio di calore.

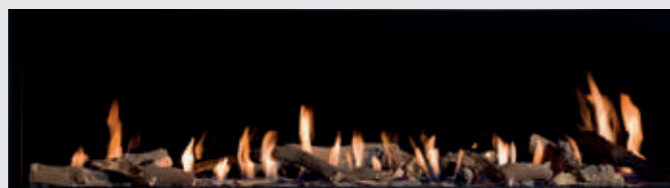

- Beide branders aan
- Les deux brûleurs allumés
- Both burners on
- Entrambi i bruciatori sono accesi

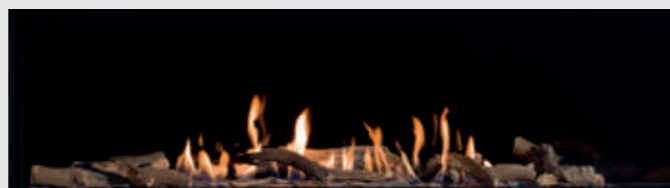

- In spaarstand; alleen middelste brander aan
- En position économique, seul le brûleur du milieu est allumé
- In the power saving mode; only the front burner on
- Nella modalità risparmio energetico, solo il bruciatore frontale è acceso



MagniFire

■ Trapsgewijs spelen met vuur

Met de MagniFire kun je in een 'lager' toestel een 3D vuurbeeld creëren. Door de schakelbaarheid van deze brander kun je besparen op je gasverbruik en heb je minder warmteafgifte. Deze brander leveren wij standaard met sfeerverlichting, voor de levensechte vuurbeleving.

■ Jouer par paliers avec le feu

Avec le MagniFire, vous pouvez créer un jeu de flammes en 3D même dans un appareil 'moins haut'. Nous livrons ce brûleur en standard avec un éclairage d'ambiance, pour une expérience du feu plus vraie que nature.

■ Step by step, playing with fire

The MagniFire can create a 3D flame image in a 'lower' appliance. The feature of switchability in this burner lets you save on gas consumption and reduces the heat output. This burner is standard supplied with ambient lighting for a lifelike fireplace experience.

■ Giocare con i livelli del fuoco

Con il MagniFire puoi creare un'immagine del fuoco 3D anche in un caminetto dall'altezza ridotta. Grazie alla regolazione di questo bruciatore potrete risparmiare sul consumo di gas, ottenendo un minor rilascio di calore. Questo bruciatore viene fornito di serie con un'illuminazione d'ambiente, per un'esperienza coinvolgente e realistica del fuoco.

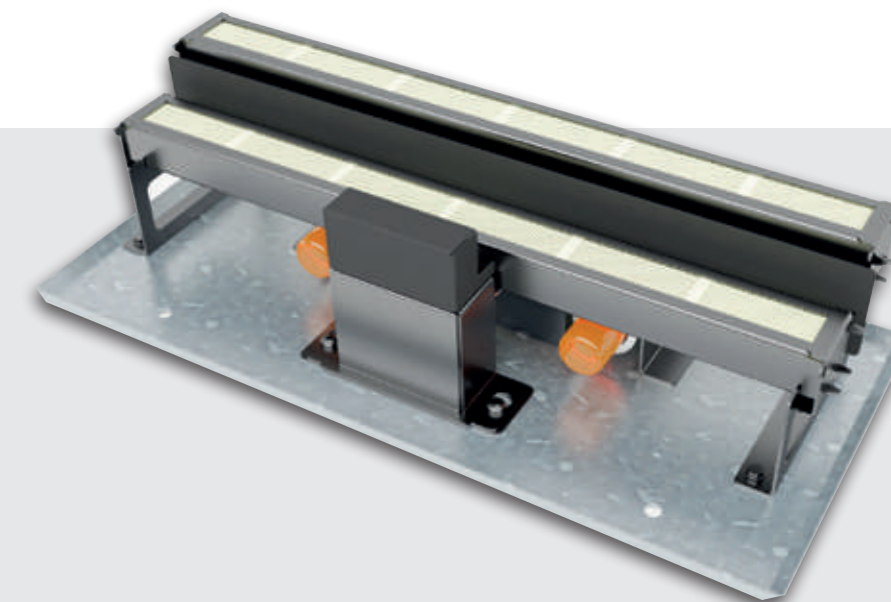

- Beide branders aan
- Les deux brûleurs allumés
- Both burners on
- Entrambi i bruciatori sono accesi



- In spaarstand; alleen voorste brander aan
- En position économique; seul le brûleur de devant est allumé
- In the power saving mode; only the front burner on
- Nella modalità risparmio energetico, solo il bruciatore frontale è acceso

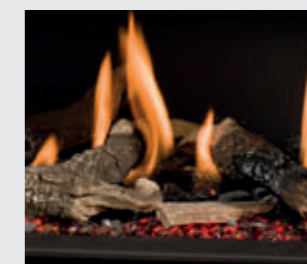

- Sfeerverlichting met vlammen
- Éclairage d'ambiance avec les flammes
- Ambient lighting with flames
- Illuminazione dell'ambiente con fiamme

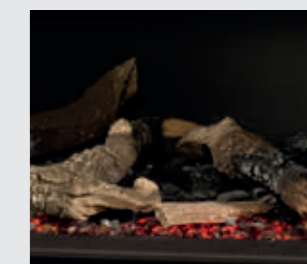

- Sfeerverlichting zonder vlammen
- Éclairage d'ambiance sans les flammes
- Ambient lighting without flames
- Illuminazione dell'ambiente senza fiamme

Overzicht schakelbare branders

Vue d'ensemble des brûleurs modulables | Overview of switchable burners | Panoramica bruciatori



Premium Fire

■ Nét echt

Een houtvuur in je kamer dankzij drie branders die in houtstammen verwerkt zijn. De voordelen van een dubbele gasbrander worden gecombineerd met de warme sfeer van een levensecht kampvuur. Door de schakelbaarheid van deze brander kun je besparen op je gasverbruik en heb je minder warmteafgifte.

■ Si réaliste

Un feu de bois dans votre pièce grâce à trois brûleurs intégrés dans des bûches. Premium Fire combine les avantages d'un double brûleur à gaz avec l'ambiance chaleureuse d'un véritable feu de camp.

■ Almost real

A wood fire in your room thanks to three burners incorporated into the logs. The advantages of a double gas burner are combined with the warm ambiance of a lifelike campfire. The feature of switchability in this burner lets you save on gas consumption and reduces the heat output.

■ Come un vero fuoco

A legna nella vostra casa grazie ai tre bruciatori incorporati nei ceppi di legno. I vantaggi di un bruciatore gas doppio combinati alla calda atmosfera regalata da un falò. Grazie alle regolazioni di questo bruciatore potrai risparmiare sul consumo di gas, ottenendo un minor rilascio di calore.



- Beide branders aan
- Les deux brûleurs allumés
- Both burners on
- Entrambi i bruciatori sono accesi



- In spaarstand; alleen voorste brander aan
- En position économique; seul le brûleur de devant est allumé
- In the power saving mode; only the front burner on
- Nella modalità risparmio energetico, solo il bruciatore frontale è acceso



- Sfeerverlichting met vlammen
- Éclairage d'ambiance avec les flammes
- Ambient lighting with flames
- Illuminazione dell'ambiente con fiamme



- Sfeerverlichting zonder vlammen
- Éclairage d'ambiance sans les flammes
- Ambient lighting without flames
- Illuminazione dell'ambiente senza fiamme



MagniFire Flow

■ Maximaal vuurbeeld

De MagniFire Flow varieert in hoogte en diepte voor een maximaal vuurbeeld rondom. Door de schakelbaarheid van deze brander kun je besparen op je gasverbruik en heb je minder warmteafgifte. Deze brander leveren wij standaard met sfeerverlichting, voor de levensechte vuurbeleving.

■ Expérience de feu incroyable

Le MagniFire Flow varie en hauteur et en profondeur pour une optimisation de la vision du feu. Nous livrons ce brûleur en standard avec un éclairage d'ambiance, pour une expérience du feu plus vraie que nature.

■ Maximum fire image

The MagniFire Flow varies in height and depth for a maximum fire image all round. The feature of switchability in this burner lets you save on gas consumption and reduces the heat output. This burner is standard supplied with ambient lighting for a lifelike fireplace experience.

■ Immagine massima del fuoco

MagniFire Flow varia in altezza e profondità per una immagine perfetta del fuoco a tutto tondo. La versatilità di questo bruciatore consente di risparmiare sul consumo di gas e riduce la potenza termica senza compromettere l'esperienza di fuoco. Questo bruciatore viene fornito con il sistema "m bianche lighting" per un'esperienza realistica e coinvolgente del fuoco.

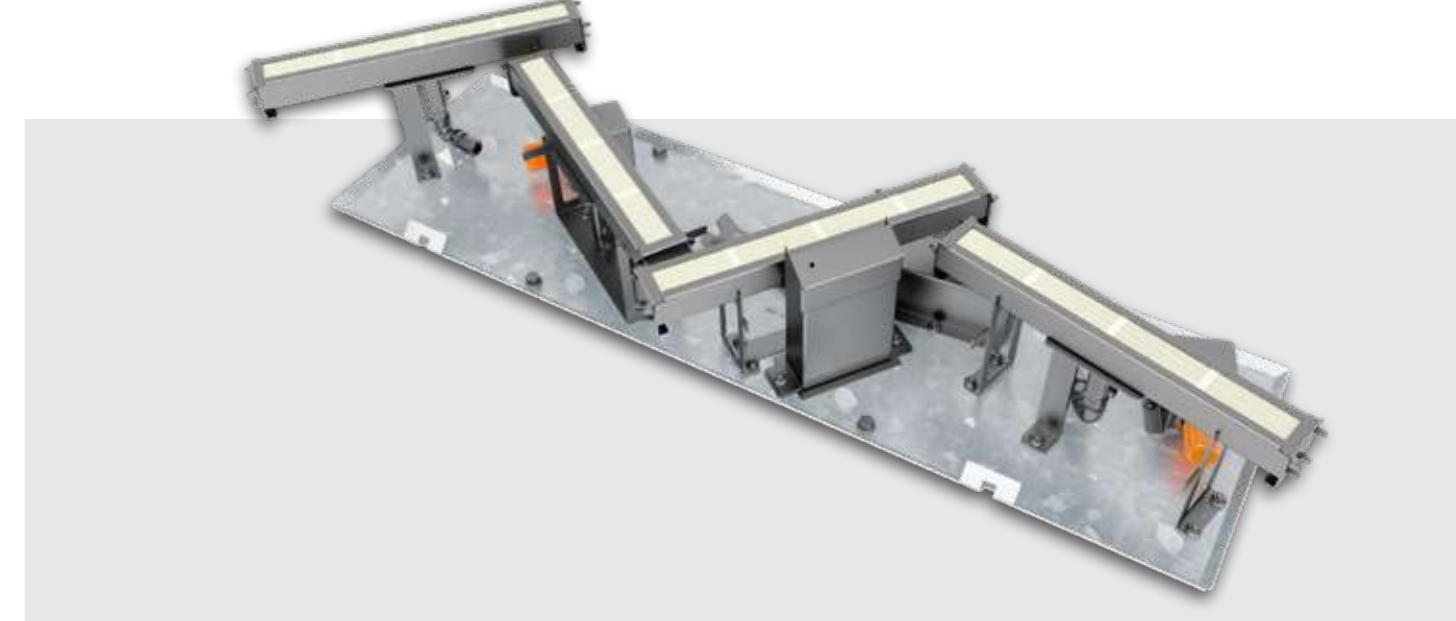

- Beide branders aan
- Les deux brûleurs allumés
- Both burners on
- Entrambi i bruciatori sono accesi

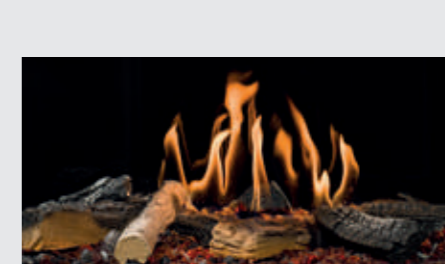

- In spaarstand; alleen voorste brander aan
- En position économique; seul le brûleur de devant est allumé
- In the power saving mode; only the front burner on
- Nella modalità risparmio energetico, solo il bruciatore frontale è acceso

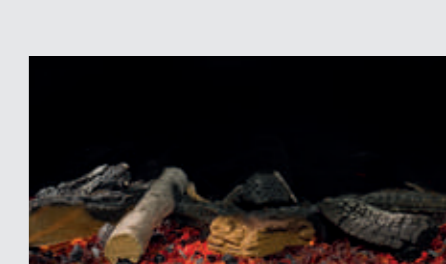

- Sfeerverlichting zonder vlammen
- Éclairage d'ambiance sans les flammes
- Ambient lighting without flames
- Illuminazione dell'ambiente senza fiamme



Interieur

Intérieurs | Interior | Interni



Smart Bell Panorama:

- Industrial interior
- Industrial interior
- Industrial interior
- Industrial interior



Original Bell - serie:

- Lamellen
- Lamelles en acier
- Steel panels
- Pannelli in acciaio



Smart Bell - / Original Bell - serie:

- Zwart keramische spiegelwand
- Miroir céramique noir
- Ceramic black mirror interior
- Parete a specchio



Smart Bell - / Original Bell - serie:

- Vlakke wand
- Paroi lisse
- Plain background
- Fondo liscio



Brander decoratie

Décorations de brûleur | Burner decoration | Decorazione bruciatori



- Houtstammen
- Bûches céramiques
- Wood logs
- Tronchetti



- Grijze kiezels
- Cailloux gris
- Grey stones
- Ciottoli grigi



Overzicht kaders

Vue d'ensemble des cadres | Overview of frames | Panoramica cornici



- Smart Bell:
- Klassiek kader - 35 mm
 - Cadre classique - 35 mm
 - Classic frame - 35 mm
 - Cornice classic - 35 mm



- Smart Bell:
- Inbouw kader
 - Cadre encastrable
 - Built-in frame
 - Cornice built-in



- Smart Bell:
- Verdiept kader - 50 mm
 - Cadre de profondeur - 50 mm
 - Insert frame - 50 mm
 - Cornice insert - 50 mm



- Original Bell:
- Hidden Door +7 cm
 - Hidden Door +7 cm
 - Hidden Door +7 cm
 - Hidden Door +7 cm



- Smart Bell:
- Klassiek kader - 52 mm
 - Cadre classique - 52 mm
 - Classic frame - 52 mm
 - Cornice classic - 52 mm



- Smart Bell:
- Verdiept kader - 15 mm
 - Cadre de profondeur - 15 mm
 - Insert frame - 15 mm
 - Cornice insert - 15 mm



- Original Bell:
- Hidden Door
 - Hidden Door
 - Hidden Door



- Original Bell:
- Floating Frame
(Optioneel inclusief AR-glas)
 - Floating Frame
(En option avec vitre anti-reflet)
 - Floating Frame
(Optionally including anti-reflective glass)
 - Floating Frame
(vetro antiriflesso disponibile a richiesta)



Overzicht kaders

Vue d'ensemble des cadres | Overview of frames | Panoramica cornici



Original Bell:
■ Hidden Door +10 cm
■ Hidden Door +10 cm
■ Hidden Door +10 cm
■ Hidden Door +10 cm



Original Bell:
■ Hidden Door +10 cm
■ Hidden Door +10 cm
■ Hidden Door +10 cm
■ Hidden Door +10 cm



Original Bell:
■ Hidden Door
■ Hidden Door
■ Hidden Door
■ Hidden Door



Room Divider:
■ Kaderloos
■ Sans cadre
■ Frameless
■ Senza cornice

Opti-Vent

Opti-Vent | Opti-Vent | Opti-Vent

- Wilt u zelf kiezen waar u uw gashaard plaatst en niet meer afhankelijk zijn van bestaande rookkanalen? Dat kan!
Dankzij de nieuwe Opti-Vent van Bellfires kunt u op elke gewenste plek in uw woning een haard plaatsen. De Opti-Vent is een mechanisch gereguleerd rookgassysteem en biedt daardoor meer vrijheid.
- Voulez-vous choisir vous-même où placer votre foyer au gaz et ne plus dépendre des conduits de fumée existants ? C'est possible !
Grâce au nouveau Opti-Vent de Bellfires, vous pouvez placer un foyer où vous le voulez dans votre maison. L'Opti-Vent est un système d'évacuation de gaz de combustion à réglage mécanique et donc offre plus de liberté.
- Would you like to make your own choice about where to put your gas fire and not be dependent on an existing chimney?
The choice is yours!
Thanks to Bellfires' new Opti-Vent you can put the gas fire anywhere in your home where ever you desire. Opti-Vent is a mechanically regulated smoke outlet system, so it gives you much more freedom.
- Ti piacerebbe scegliere dove mettere il tuo caminetto a gas e non dipendere dalla posizione della canna fumaria esistente? La scelta è tua!
Grazie al nuovo Opti-Vent di Bellfires puoi installare il tuo caminetto a gas ovunque desideri nella casa. Opti-Vent ti dà anche più libertà di progettazione su dove posizionare l'intera unità. Opti-Vent è un sistema di uscita del fumo regolato meccanicamente e ti dà molta più libertà.

- Voordelen van de Opti-Vent:
 - Veel vrijheid voor de positie van de haard in de ruimte en de rookgasafvoer naar de buitenzijde van uw woning
 - Mogelijk voor zowel aardgas als propaan
 - Volledig mechanisch en zelf regulerend systeem
 - Mogelijk om te werken met een kleiner kanaal

- Les avantages de l'Opti-Vent :
 - Beaucoup de liberté pour la position du foyer dans la pièce et l'évacuation des fumées vers l'extérieur de votre maison
 - Possibilité pour le gaz naturel et le propane
 - Système entièrement mécanique et autorégulé
 - Possibilité d'utiliser un conduit plus petit

- Advantages of Opti-Vent:
 - More freedom in placing the gas fire in the room, with the smoke outlet on the outside of your house
 - Suitable for both natural gas and propane
 - Fully mechanical, self-regulating system
 - Accommodates a smaller exhaust pipe

- Vantaggi di Opti-Vent:
 - più libertà nel posizionare il tuo caminetto a gas nella stanza, con l'uscita del fumo all'esterno della tua casa.
 - Adatto sia per gas naturale che per il propano
 - Sistema completamente meccanico e autoregolante
 - Accoglie un tubo di scarico di diametro ridotto

Service en garantie

Service et garantie | Service and warranty | Assistenza e garanzia

■ Een tophaard van Bellfires verdient de allerbeste service. Jouw dealer zal een eventuele storing zo snel mogelijk verhelpen, zo nodig ondersteund door het Bellfires-serviceteam. Bellfires geeft 10 jaar garantie op de romp van het toestel en 2 jaar op onderdelen. Voor verbruiksonderdelen geven wij eenzelfde garantie tot na de eerste stook. Bellfires garandeert dat vitale onderdelen nog minimaal 10 jaar na stopzetten van de productie leverbaar blijven.

Onze haarden worden uitsluitend geleverd via een netwerk van deskundige Bellfires dealers die garant staan voor een verantwoorde en veilige installatie. Tot in lengte van dagen genieten van jouw haardvuur? Laat dan jouw dealer jaarlijks onderhoud aan de installatie verrichten.

■ Un appareil haut de gamme Bellfires mérite ce qu'il y a de mieux en matière de service. C'est la raison pour laquelle votre revendeur agréé réparera le plus vite possible une panne éventuelle, le cas échéant soutenu par l'équipe technique du service Bellfires. Bellfires accorde 10 ans de garantie sur la structure de votre appareil (hors peinture) et 2 ans sur l'ensemble des autres pièces et mécanismes. Pour les pièces sujettes à usure (voir notices) et pour la vitre, la garantie s'achève dès la première utilisation. Bellfires garantit que les pièces nécessaires au bon fonctionnement de votre appareil resteront disponibles et livrables pendant au moins 10 ans après l'arrêt de la production.

Nos appareils sont livrés exclusivement par le biais d'un réseau de revendeurs Bellfires compétents, qui garantissent une installation responsable et sûre. Vous voulez profiter plus longtemps de votre cheminée ? Confiez l'entretien annuel de l'installation à votre revendeur.

■ A top fireplace of Bellfires deserves the very best service. Your dealer will help you with any failure as fast as possible, if necessary, assisted by a Bellfires Service Team. Bellfires gives you a 10-year warranty on the body of the appliance and 2 years on the parts. For consumables, we give the same warranty up to the first burning of the appliance. Bellfires guarantees that vital parts will be available at least 10 years after the production of the model has stopped.

Our fireplaces are supplied only via a network of professional Bellfires dealers who guarantee responsible and safe installation. Want to enjoy your fireplace without end? Then let your dealer carry out an annual maintenance to your appliance.

■ Un camino Bellfires si merita la migliore assistenza. Il rivenditore risolverà eventuali problemi il più rapidamente possibile, supportato, se necessario dal team di assistenza Bellfires. Bellfires offre 10 anni di garanzia sulla struttura del camino e 2 anni sui componenti. Per i materiali di consumo offriamo la stessa garanzia fino alla prima accensione. Bellfires garantisce che i pezzi vitali rimarranno disponibili per almeno 10 anni dopo l'interruzione della produzione.

I nostri camini vengono forniti esclusivamente attraverso una rete di rivenditori esperti di Bellfires che garantiscono un'installazione responsabile e sicura. Volete godervi il vostro camino in tutta tranquillità e per lungo tempo? Fate eseguire la manutenzione annuale al vostro rivenditore.

■ Disclaimer

Deze brochure is met uiterste zorg samengesteld. Toch bestaat altijd de mogelijkheid dat bepaalde informatie verouderd of niet langer compleet is. Barbas Bellfires is niet verantwoordelijk voor beslissingen die enkel en alleen op basis van deze brochure genomen zijn. Barbas Bellfires adviseert daarom altijd eerst professioneel en deskundig advies in te winnen.

Aan gepubliceerde foto's kunnen geen rechten worden ontleend. Ze zijn uitsluitend bedoeld om een sfeerimpressie van mogelijke opstellingen te tonen.

■ Disclaimer

Cette brochure a été réalisée avec le plus grand soin. Malgré cela, il se peut toujours que certaines informations soient obsolètes ou ne soient plus complètes. Barbas Bellfires décline toute responsabilité pour des décisions prises uniquement sur la base de cette brochure. Par conséquent, Barbas Bellfires recommande de toujours solliciter au préalable un avis professionnel et compétent.

Les photos publiées ne confèrent aucun droit. Elles sont uniquement destinées à donner une impression d'ambiance des configurations possibles.

■ Disclaimer

This brochure was put together with utmost care. Nevertheless, there is always the possibility that certain information is outdated or no longer complete. Barbas Bellfires is not responsible for decisions made based only on the brochure. That is why Barbas Bellfires always advises you to first gather professional and expert advice.

No rights can be derived from the photos published. They are intended exclusively for giving an impression of the atmosphere and of possible set-ups.

■ Disclaimer

Questa brochure è stata redatta con grande cura. Tuttavia può accadere che alcune informazioni non siano aggiornate o complete. Barbas Bellfires non è responsabile di decisioni prese solo ed esclusivamente sulla base di questa brochure. Barbas Bellfires consiglia perciò di rivolgersi sempre per una consulenza ad un professionista esperto.

Nessun diritto può derivare dalle foto pubblicate. Queste sono esclusivamente a scopo dimostrativo delle possibili configurazioni e dell'ambientazione del prodotto.

Barbas Bellfires

Hallenstraat 17 | NL - 5571 AB Bladel | The Netherlands

NL: T + 31 (0)497 33 92 00
info@barbasbellfires.nl
www.barbasbellfires.nl

FR: T + 33 (0)183 792 960
info@barbasbellfires.fr
www.barbasbellfires.com/fr

UK: T + 44 15 62 54 89 70
info@barbasbellfires.com
www.barbasbellfires.com

belfires. fireplaces